

# PROJETO DE REFORMA REFEITÓRIO DE SOLDADOS

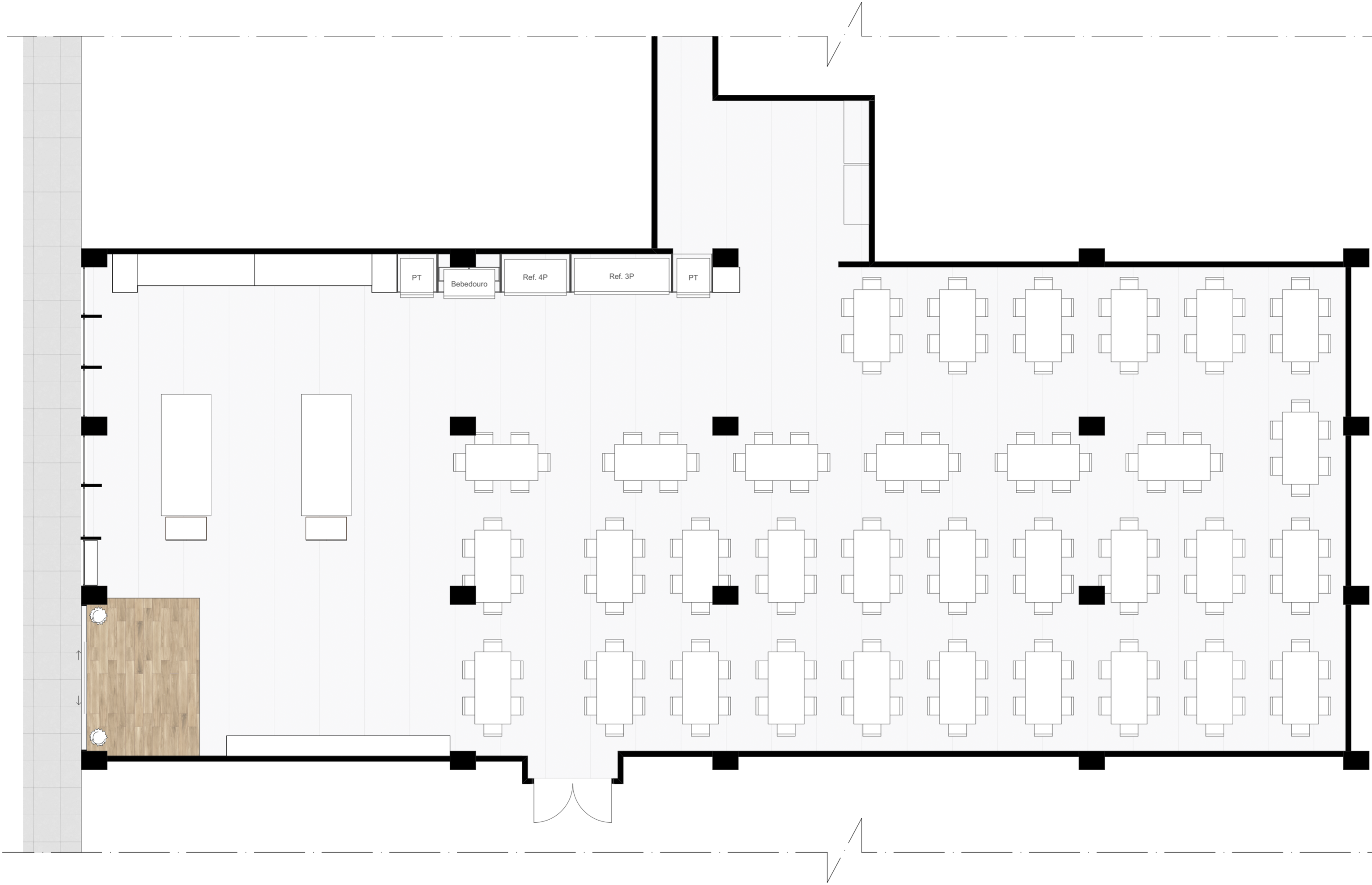

Layout  
Escala: 1:75

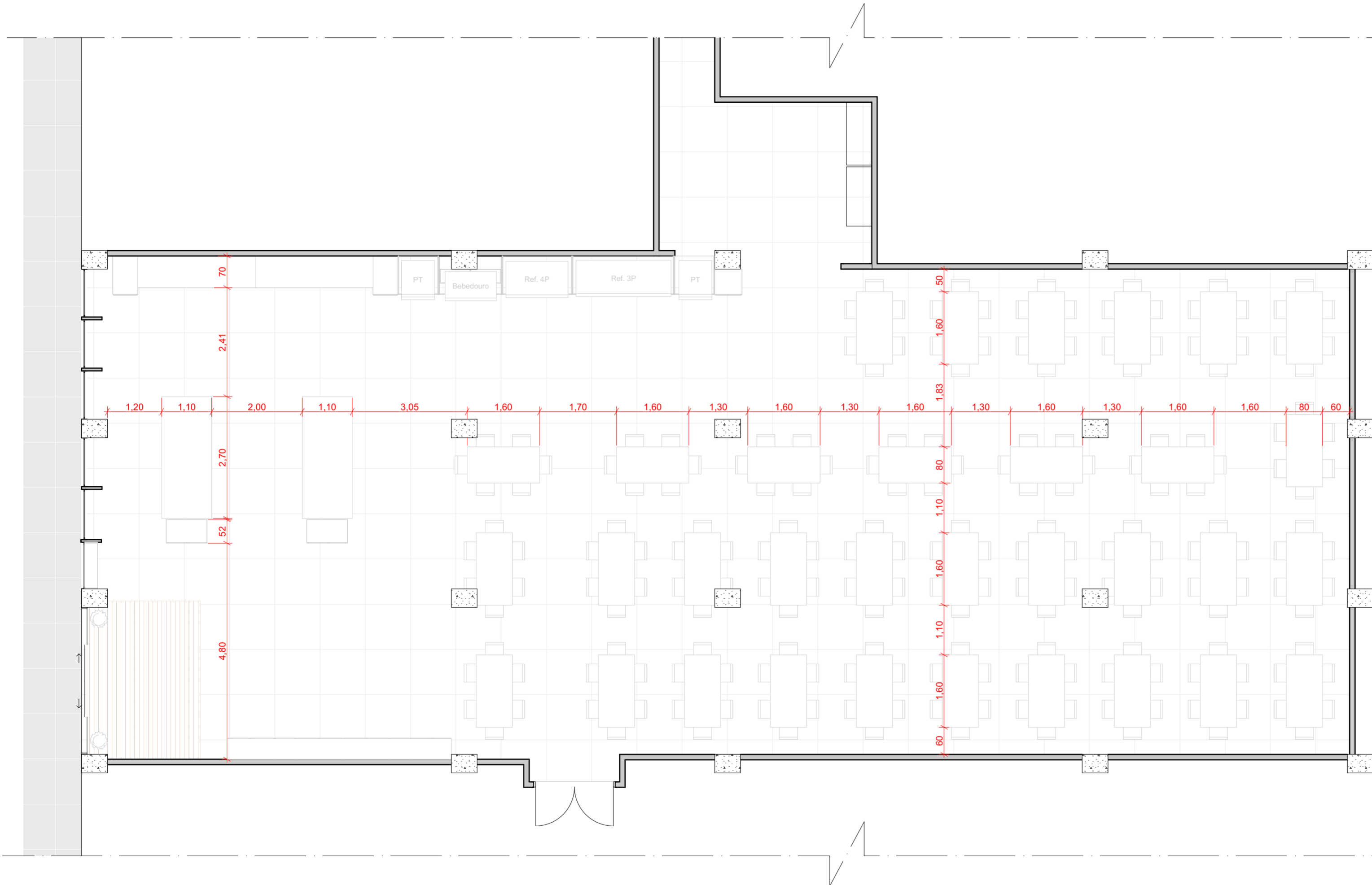

Projeto Arquitetônico  
Escala: 1:75

OBSERVAÇÕES

**198 ASSENTOS**  
**33 MESAS**

LEGENDA:

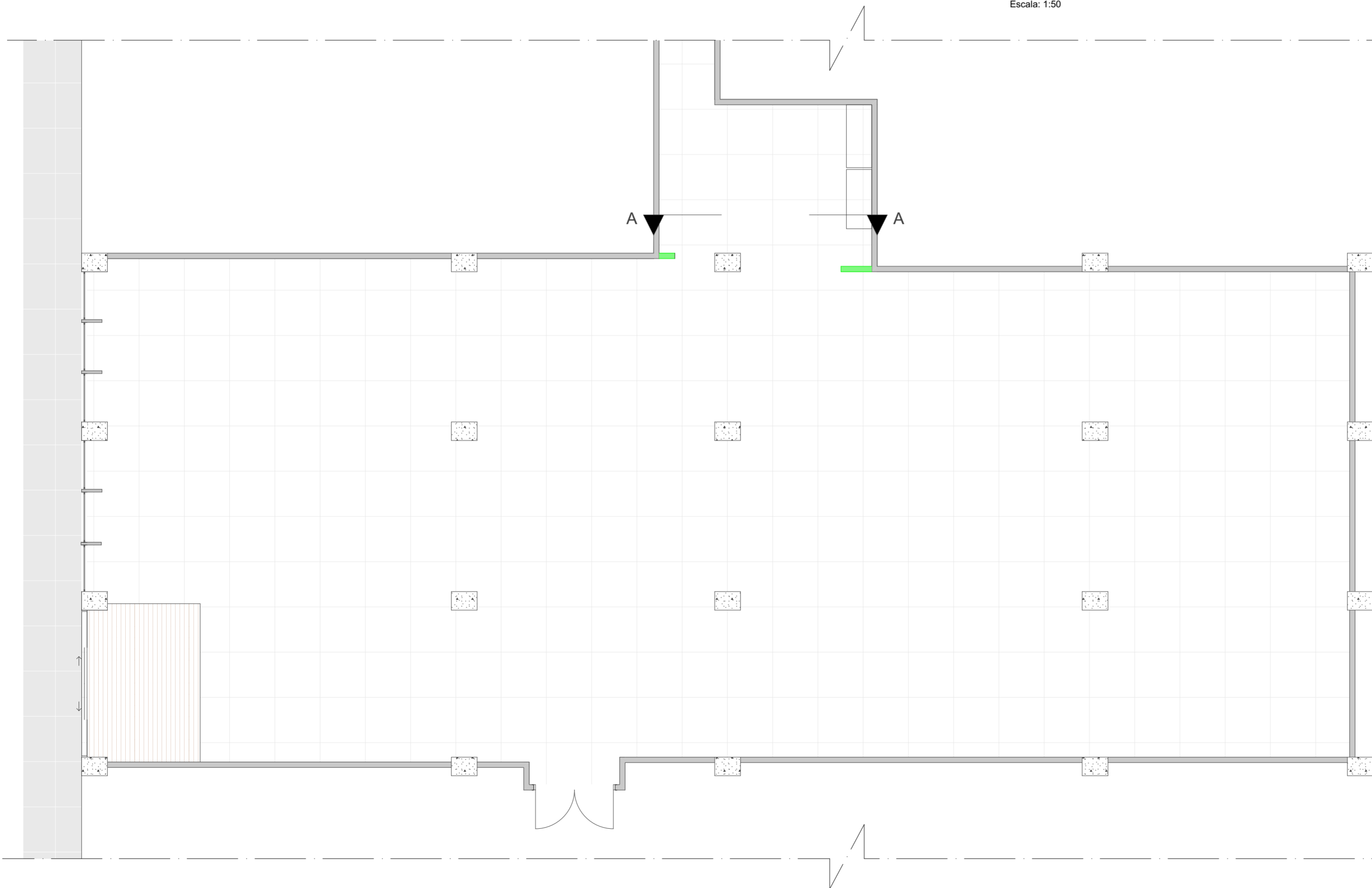

Corte A1  
Escala: 1:50

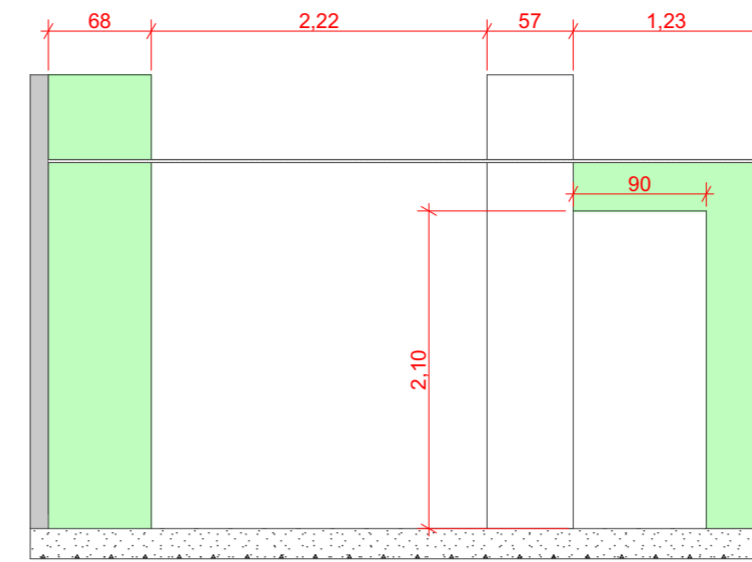

OBSERVAÇÕES

- LEGENDA:
- a Construir
  - a Demolir

Construções / Demolições  
Escala: 1:75

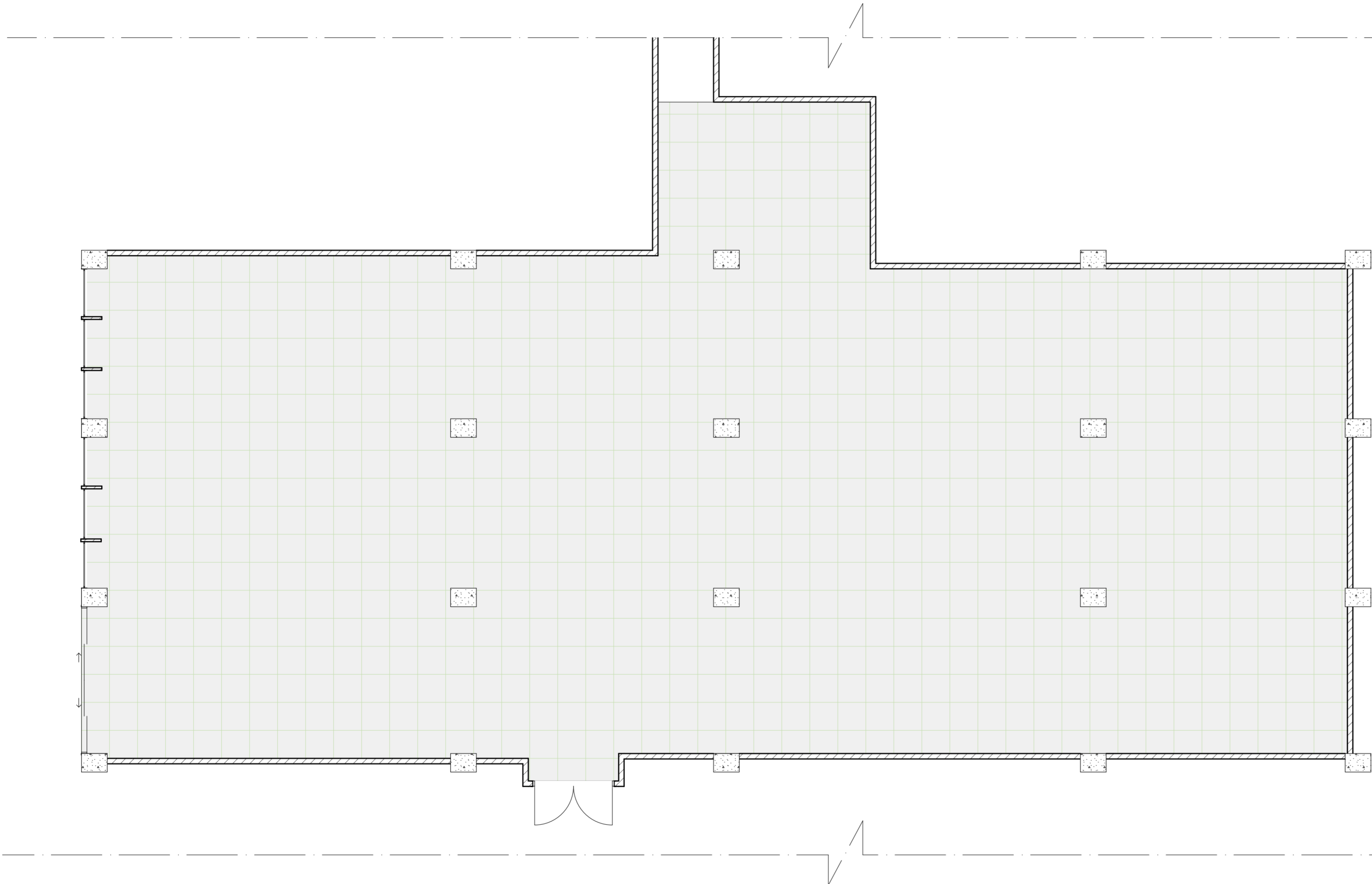

**Forro**  
Escala: 1:75

OBSERVAÇÕES

LEGENDA:

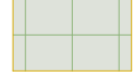
 Forro Modular 625x625x15mm de Fibra Mineral, na cor branco, com perfil de aço galvanizado na cor Branco. Área Total: 320m². H= 2,45m. A construir;

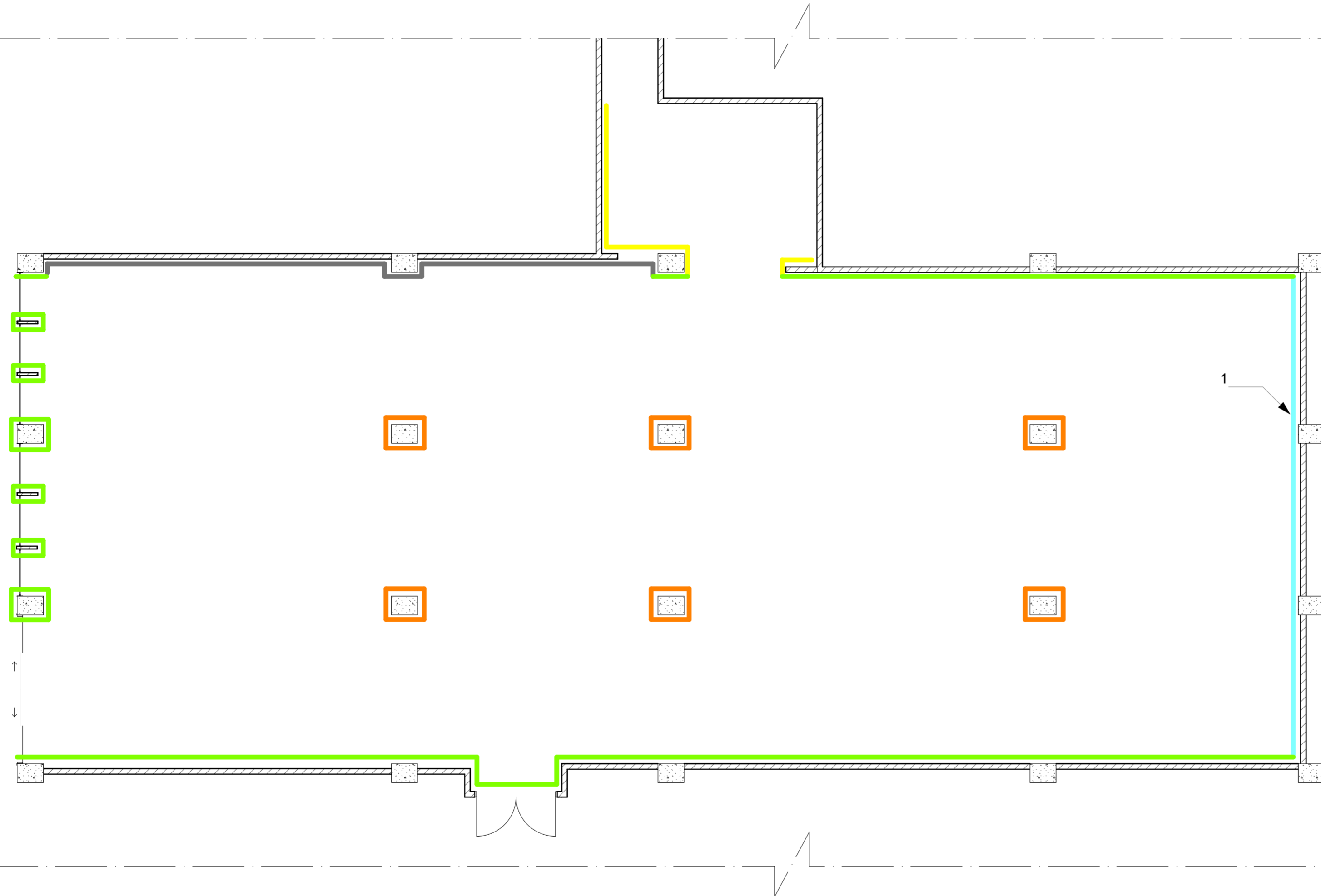

**OBSERVAÇÕES**

1- Nivelar Ressaltos entre paredes e pilares da parede do fundo (+/- 5cm) com placa cimentícia de 10mm e estrutura metálica galvanizada.

**LEGENDA:**

- Pintura acrílica na cor branco Acetinado. Área total: 90m<sup>2</sup>
- Revestimento de MDF EUCATEX Peroba Rosa Com base metálica na cor cinza claro. Área total: 25m<sup>2</sup>
- Revestimento Cerâmico 30x30 Branco Alto Brilho. Área Total: 15m<sup>2</sup>
- Revestimento Ink Artens Paulo Bianchini 20x20. Área Total: 28m<sup>2</sup>
- Pintura acrílica na cor branco Grafite Lapiseira (Suviniil). Área total: 35m<sup>2</sup>

**Acabamento Paredes**

Escala: 1:75

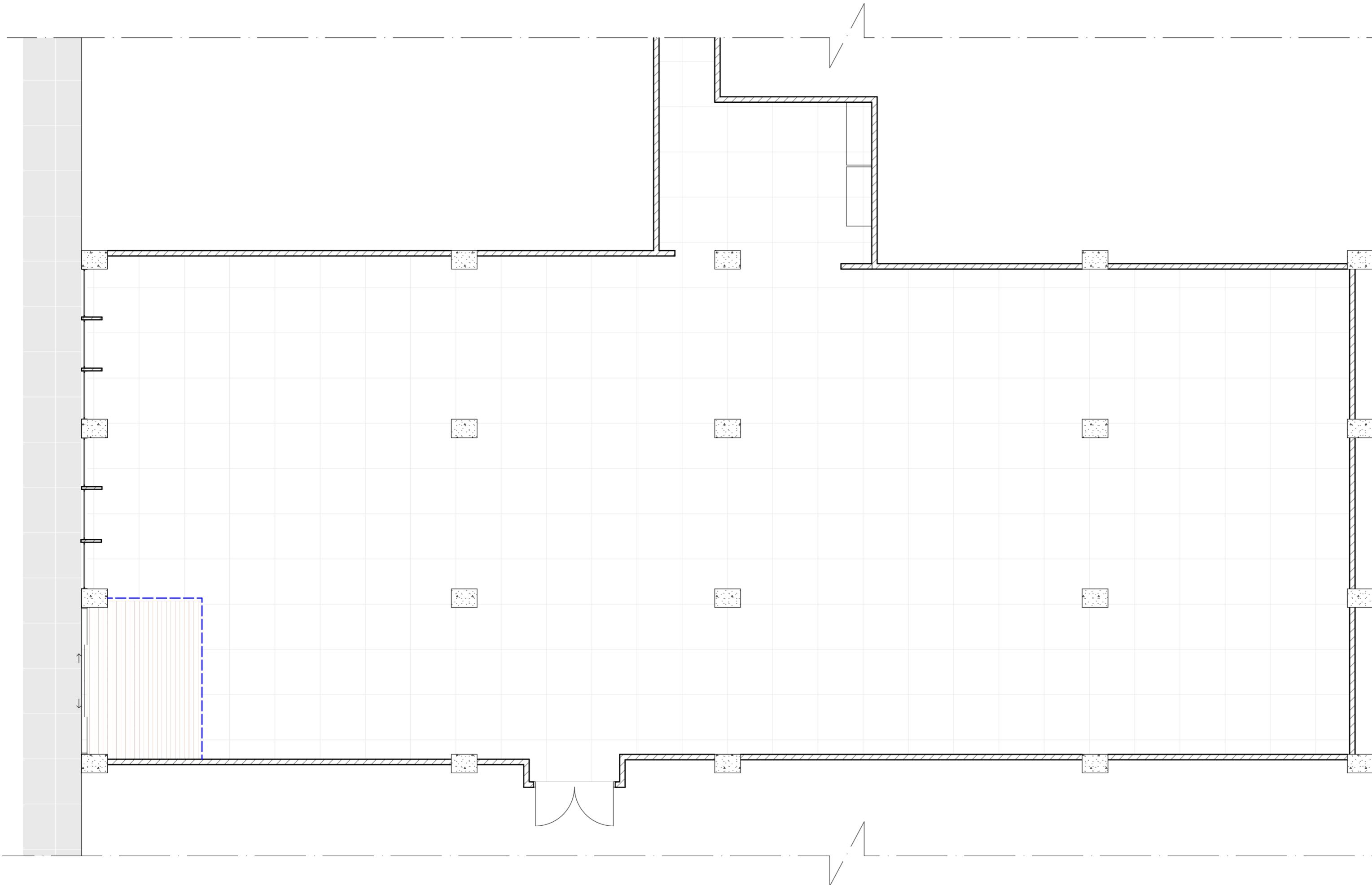

Acabamento Pisos  
Escala: 1:75

OBSERVAÇÕES

LEGENDA:

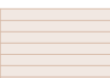
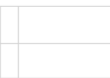
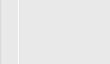
-  Pedra de acabamento tipo Granito na cor BEGE BAHIA sem acabamentos nas laterais. Dimensões: Largura:10cm. Comprimento Total: 6m
-  Revestimento tipo Porcelanato na cor "Carvalho Acetinado" ou "Peroba" 100x20cm. Área total: 10m<sup>2</sup>
-  Piso existente. Manter.
-  Piso externo existente. Manter.

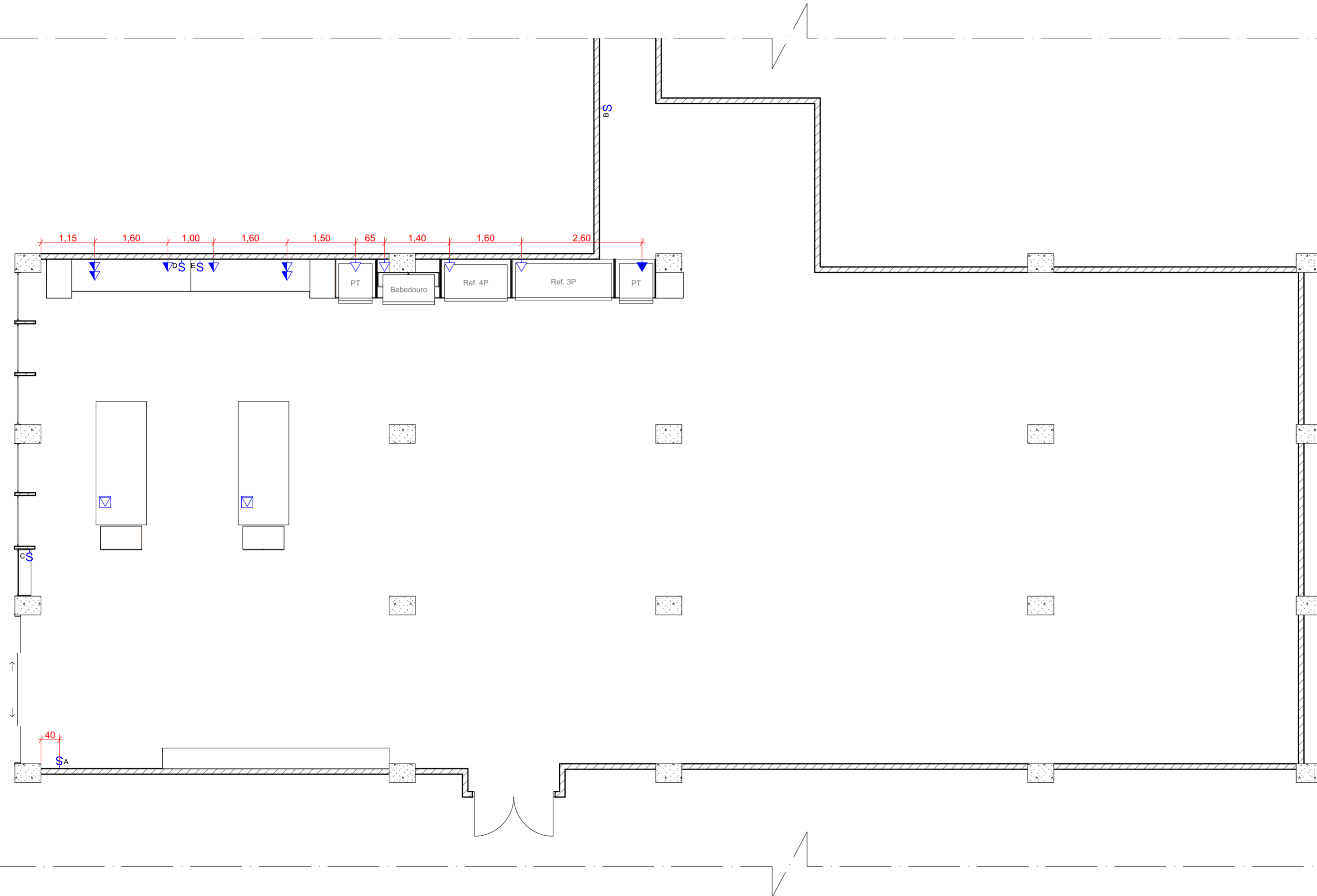

**Pontos Elétricos**  
Escala: 1:75

OBSERVAÇÕES

LEGENDA:

- ▽ Ponto de Tomada baixa. 30cm
- ▽ Ponto de Tomada média. 110cm
- ▽ Ponto de Tomada alta. 180cm
- Ⓢ Ponto de Interruptor. 110cm
- ☒ Ponto de tomada de piso

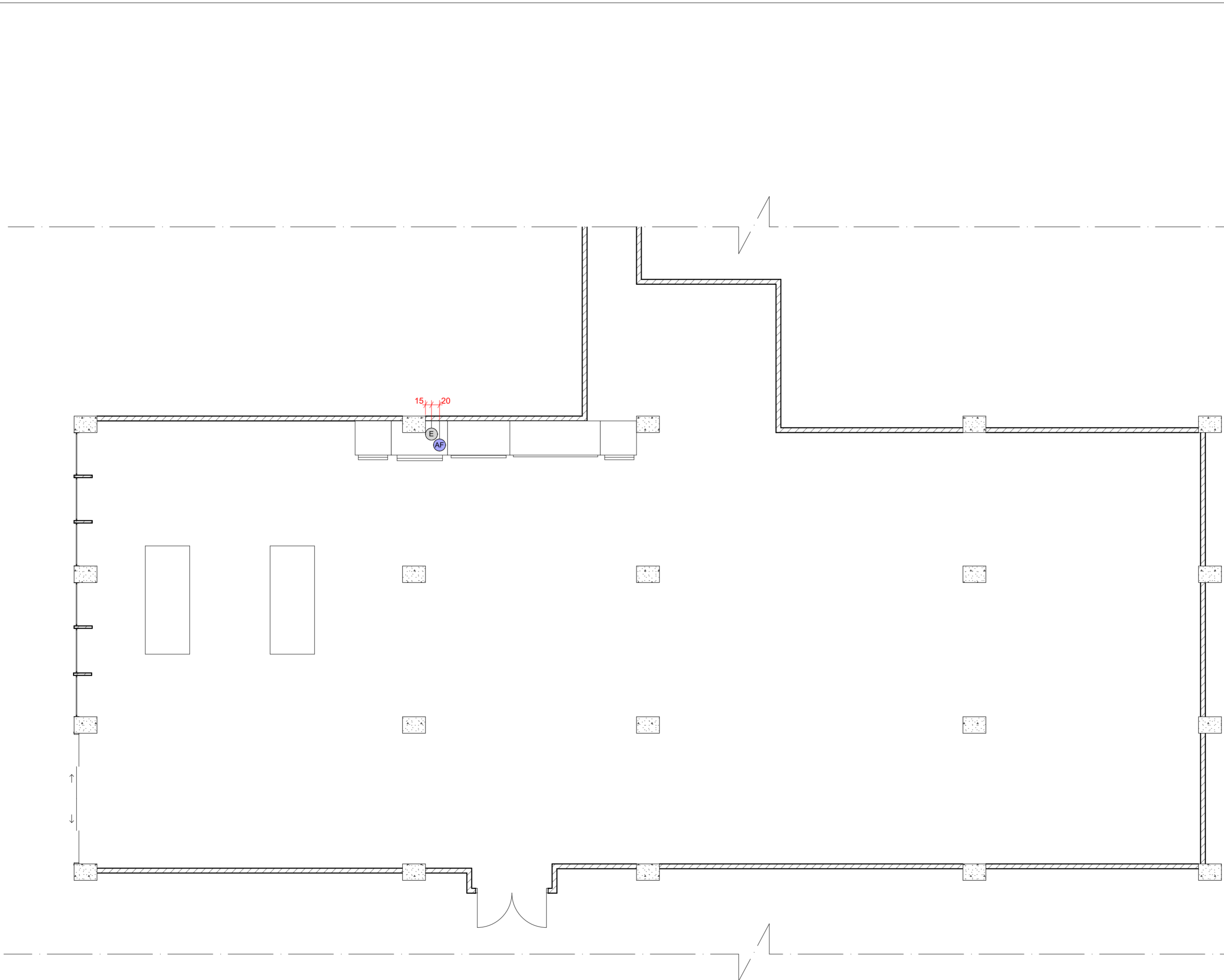

Pontos Hidráulicos  
Escala: 1:75

OBSERVAÇÕES





LEGENDA:

- AF — Ponto de água fria. 60cm
- E — Ponto de Esgoto. 50cm



OBSERVAÇÕES

LEGENDA:

-  Perfil de LED 24mm de Embutir com Fita de LED 120LED/ 2700K. (12m), 3 Fontes
-  Spot de embutir Branco, recuado, direcionável PAR20. 3000K, 8W (25 un)
-  Plafon de embutir 62,5x 62,5cm 45W, 4000K na cor Branco. (26 un)
-  Lâmpada de Secagem Infravermelha 250W E27 (4un)

Iluminação

Escala: 1:75

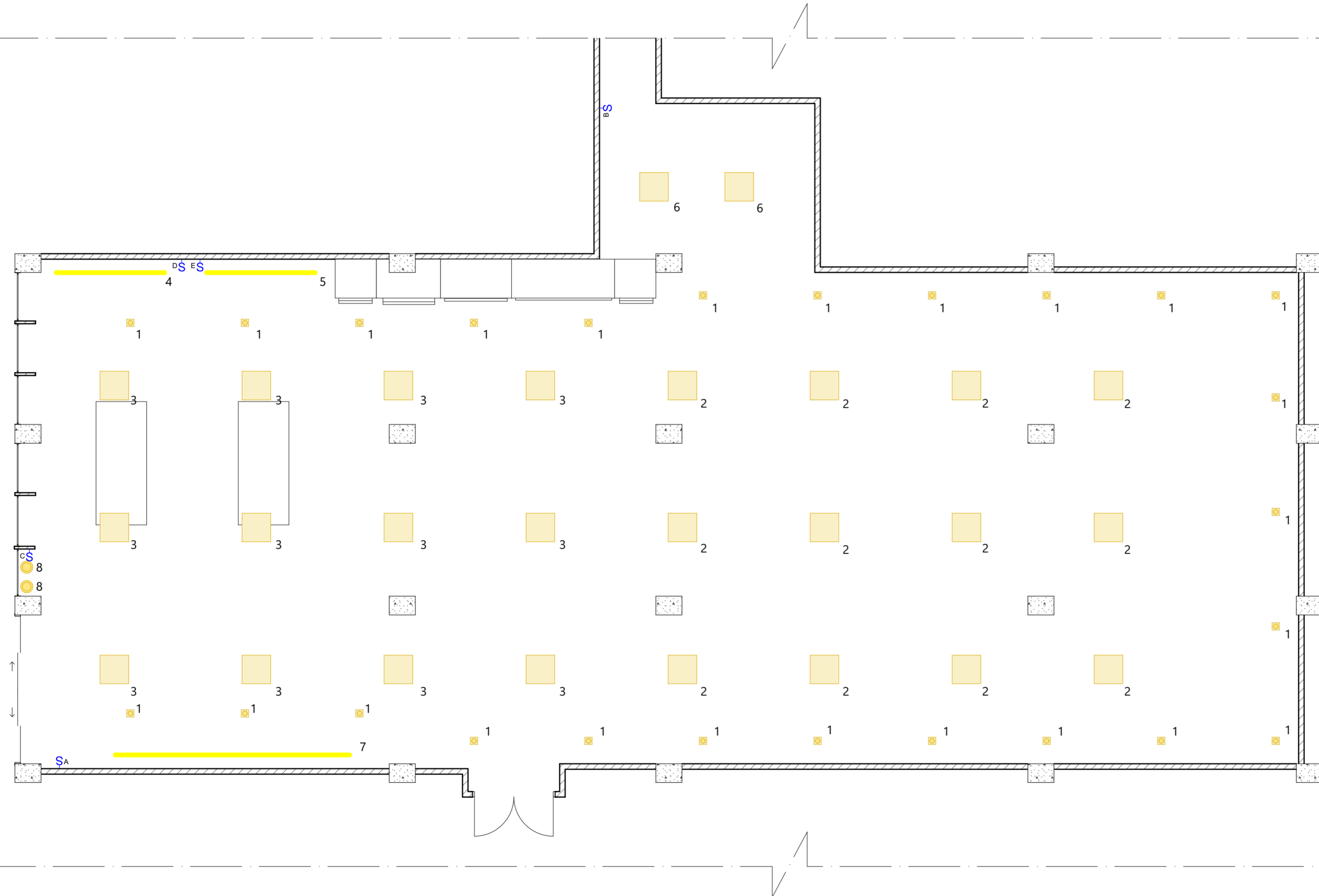

**Circuitos**  
Escala: 1:75

OBSERVAÇÕES

CIRCUITOS:

INT	CIRCUITOS
A	1 - 2 - 3 - 7
B	1 - 2 - 3 - 6
C	8
B	4
C	5

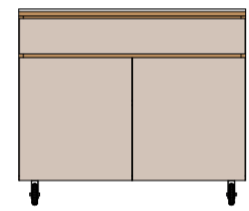
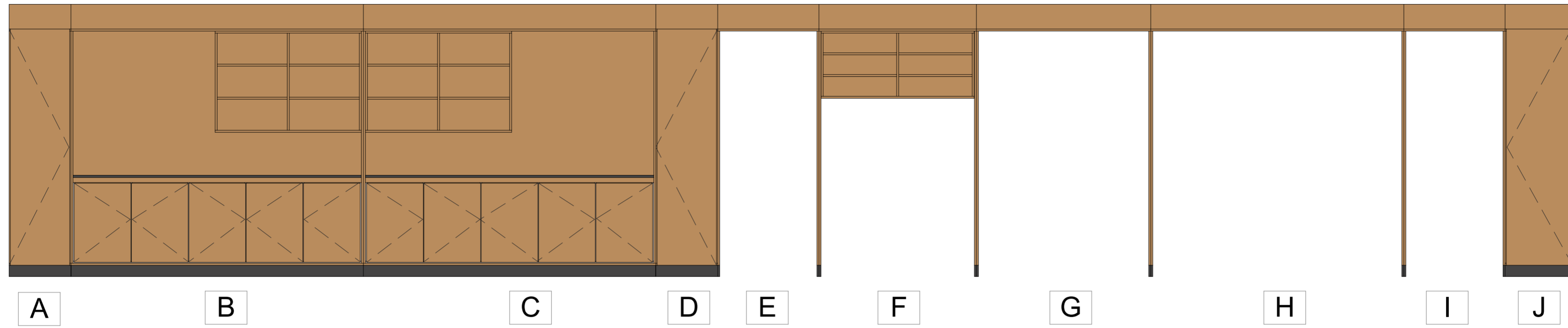

K

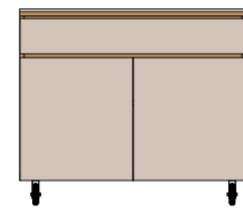

L

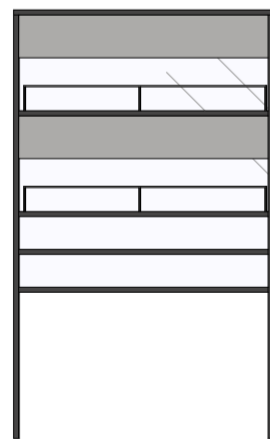

M



O

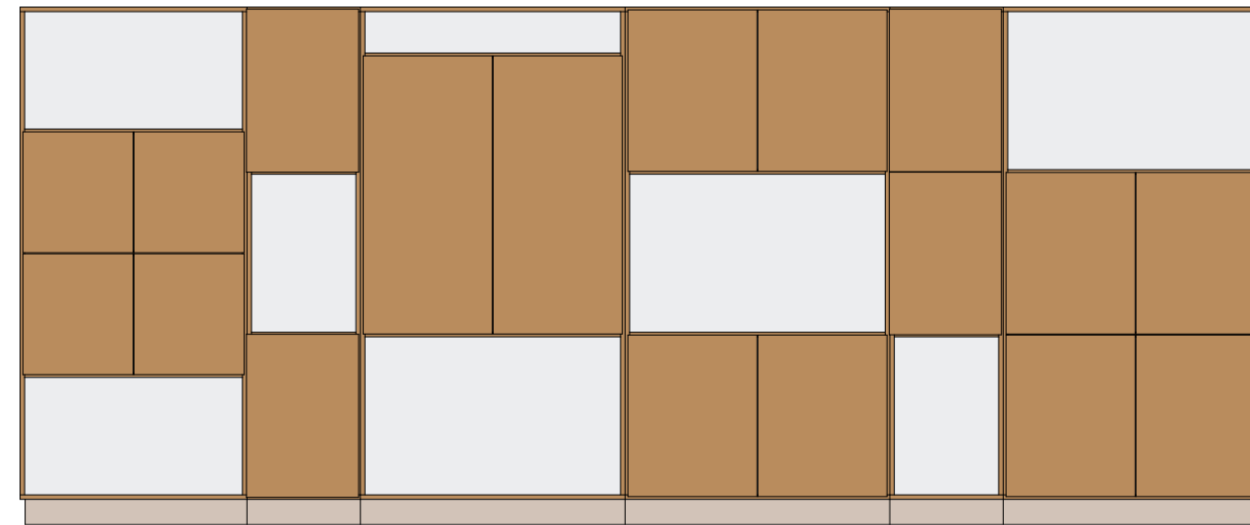

N



### E= I - PASS THROUGH (2UN)

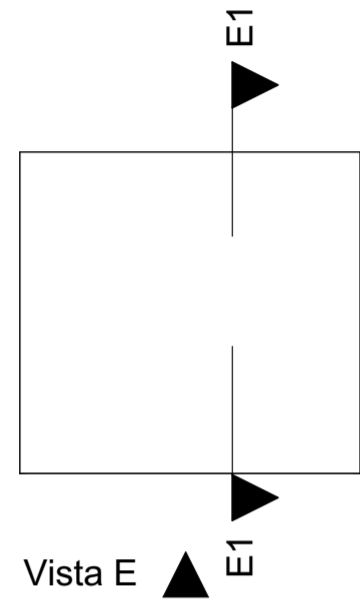
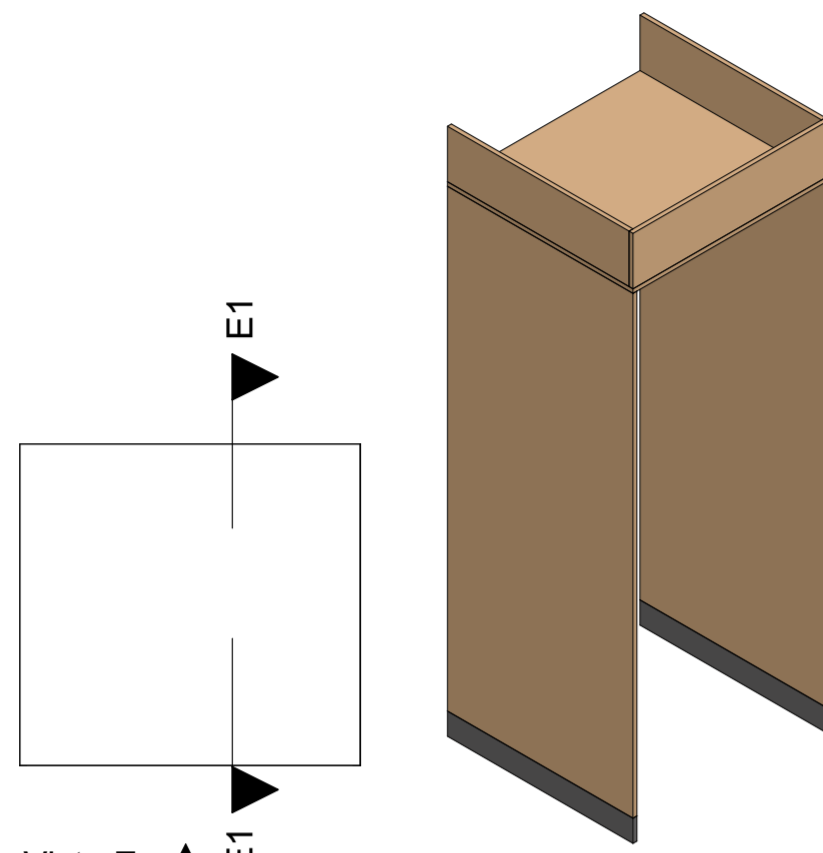

Vista Superior  
Escala: 1:20

Perspectiva  
Escala: 1:30

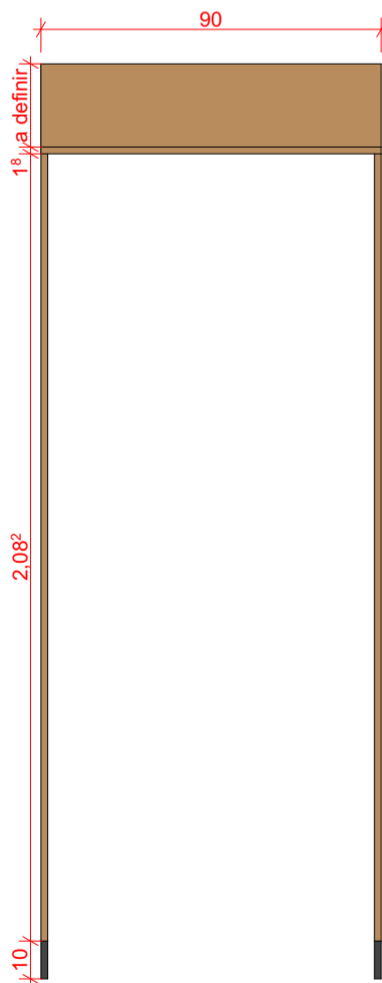

Vista E  
Escala: 1:20

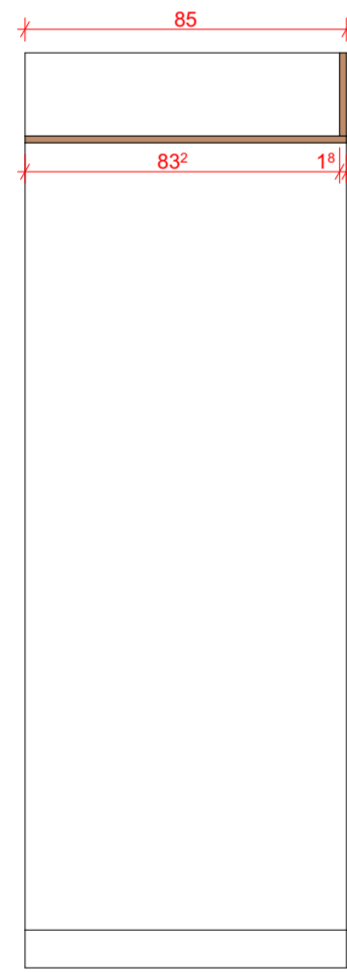

Corte E1  
Escala: 1:20

### F - BEBEDOURO

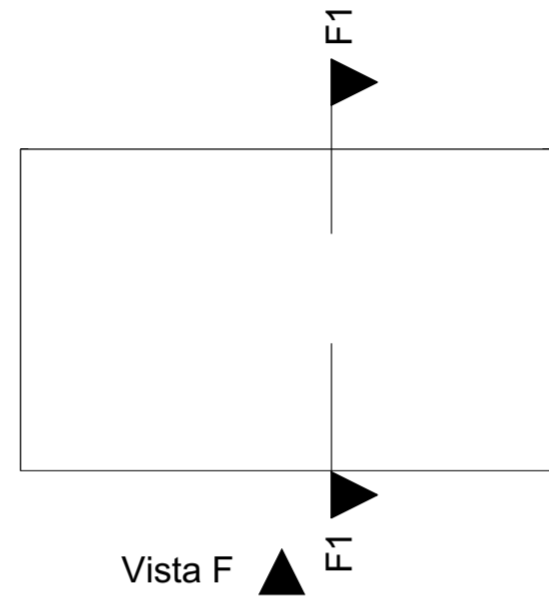
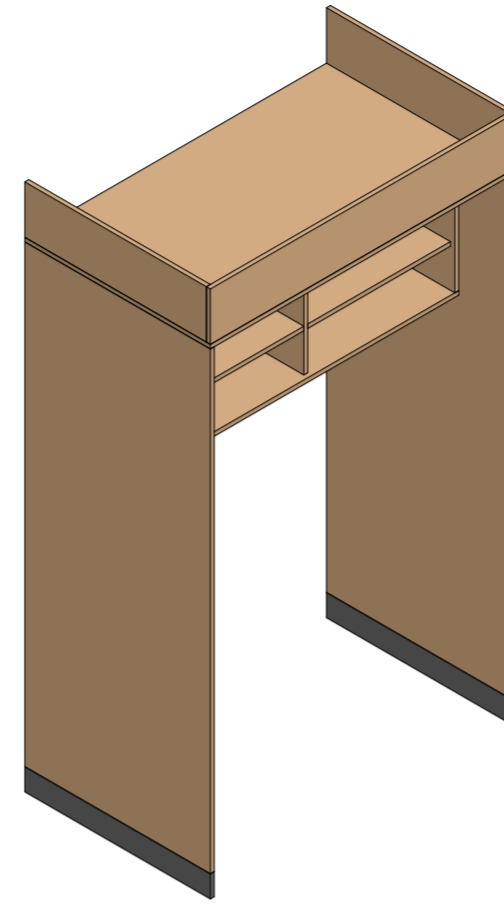

Vista Superior  
Escala: 1:20

Perspectiva  
Escala: 1:30

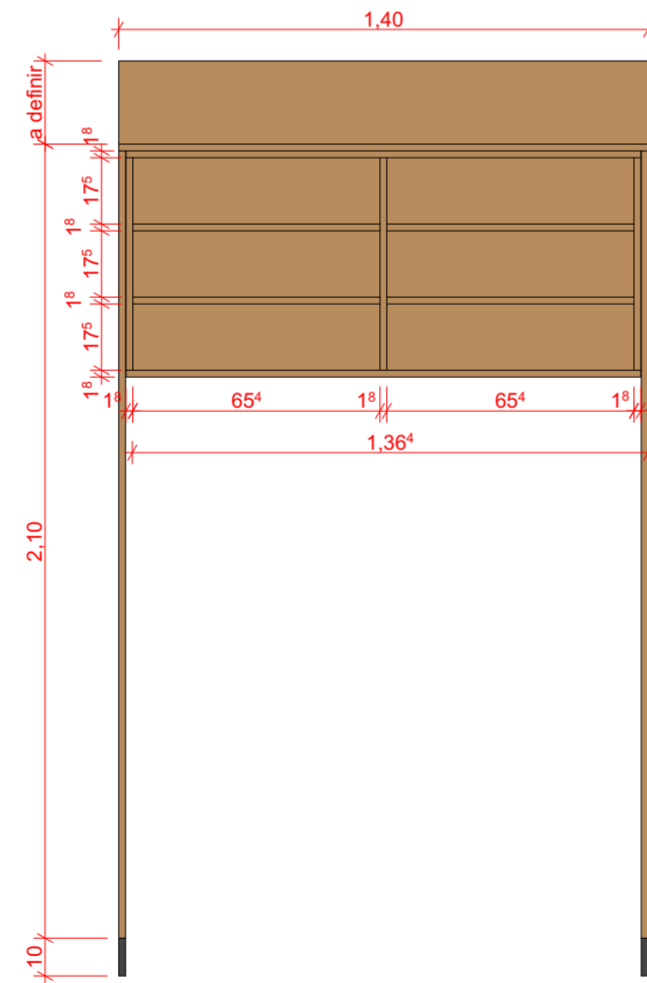

Vista F  
Escala: 1:20

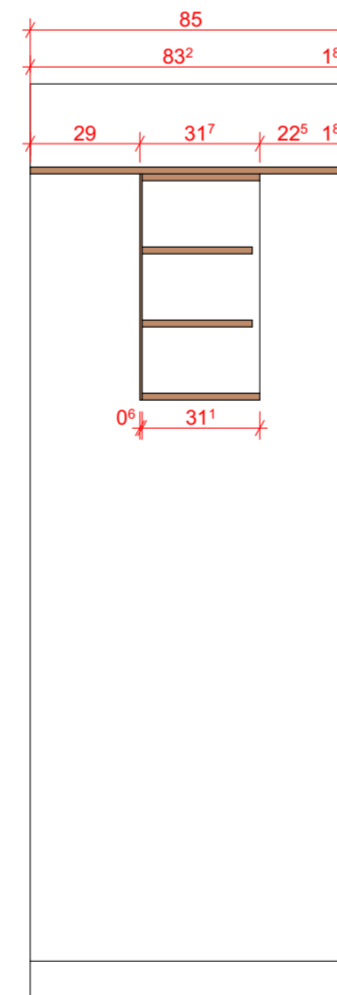

Corte F1  
Escala: 1:20

### G - REFRIGERADOR 4P

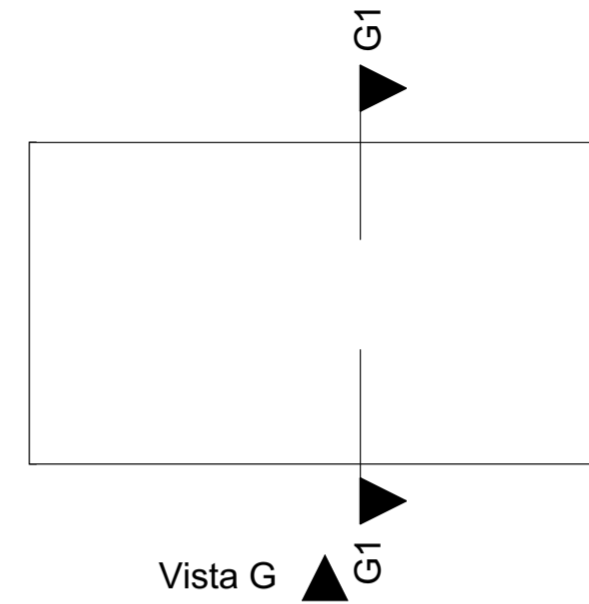
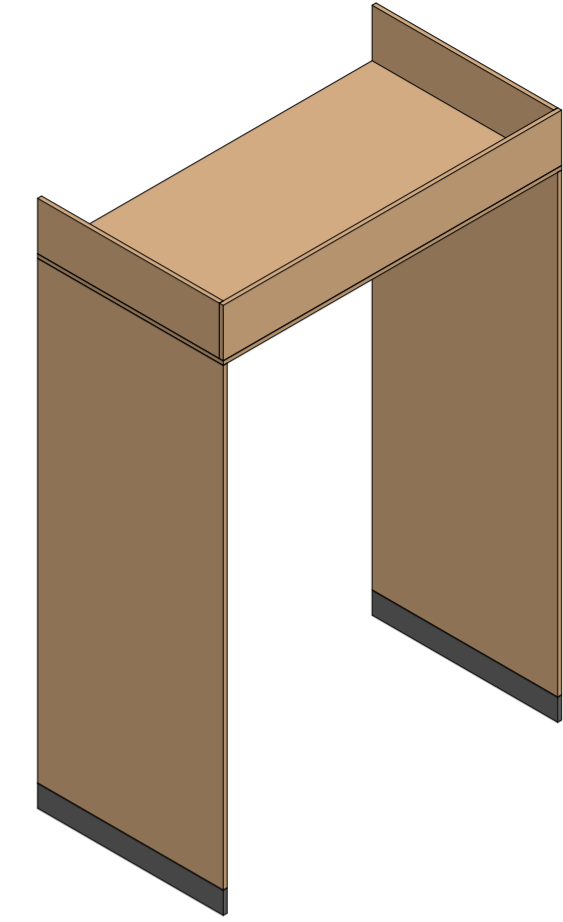

Vista Superior  
Escala: 1:20

Perspectiva  
Escala: 1:30

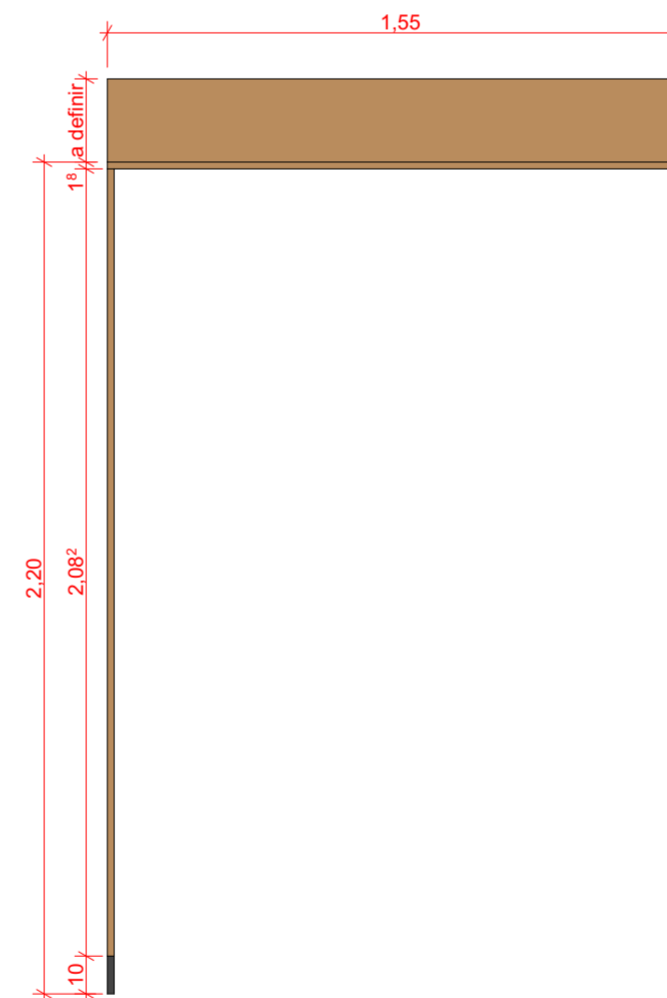

Vista G  
Escala: 1:20

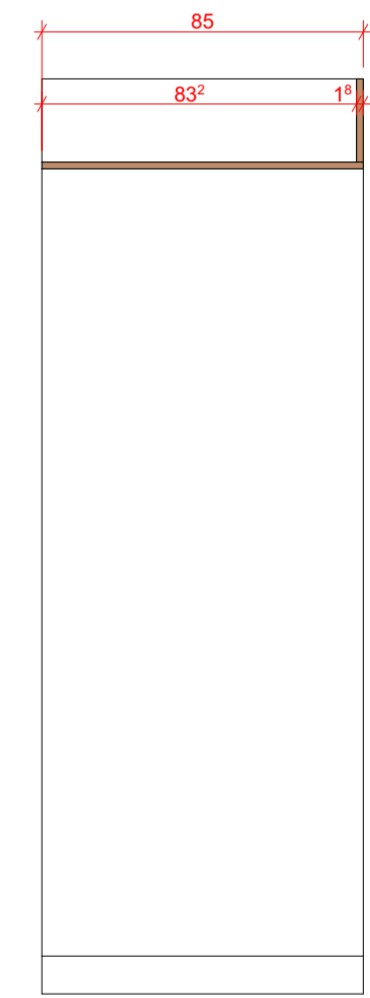

Corte G1  
Escala: 1:20

OBSERVAÇÕES:

- 1- TODA MOBÍLIA é em MDF EUCATEX PEROBA ROSA 6mm e 18mm
- 2- Soleiras de todos armários em Granito São Gabriel 10cm.
- 3- Altura da Peça de fechamento superior a depender do pé direito livre. Medir no local.
- 4- Armário do Bebedouro deverá ter recorte do pilar existente. Medir no local.

### H - REFRIGERADOR 3P

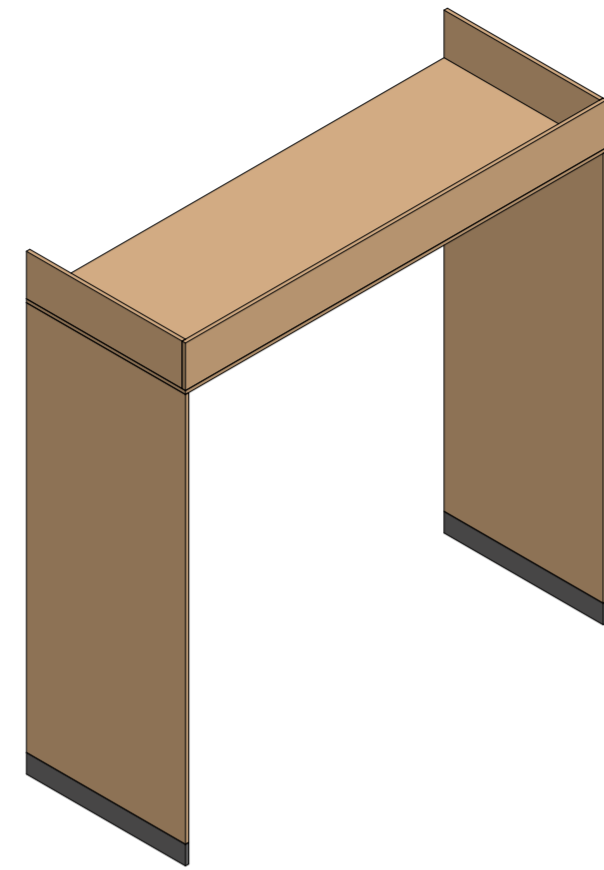

Perspectiva  
Escala: 1:35

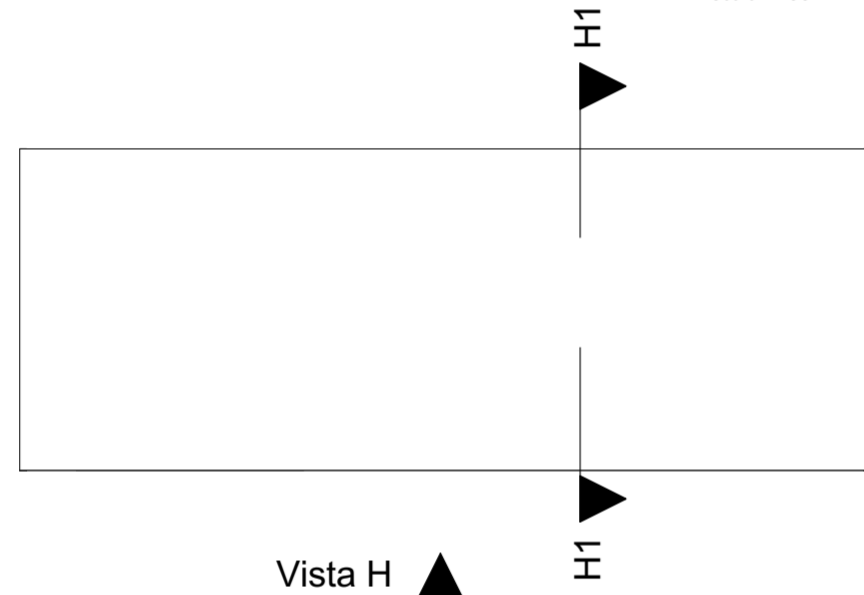

Vista H ▲

Vista Superior

Escala: 1:20

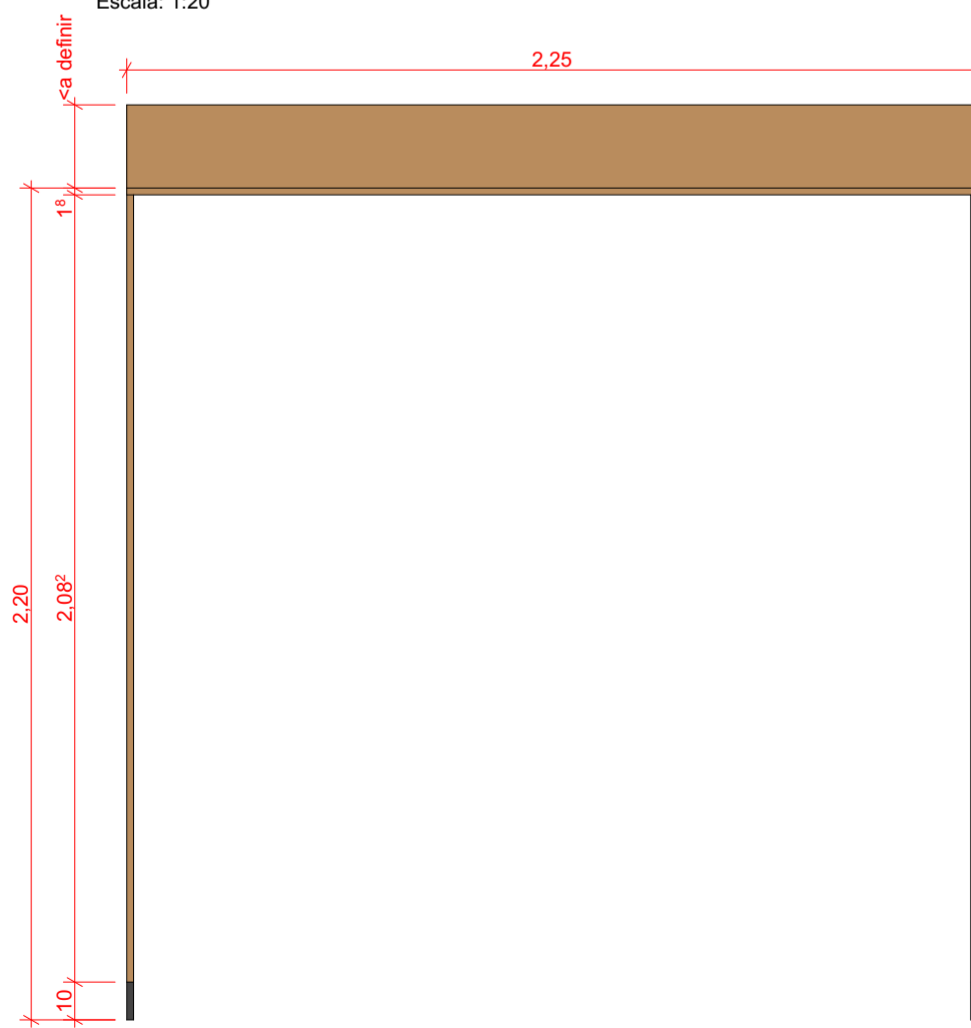

Vista H  
Escala: 1:20

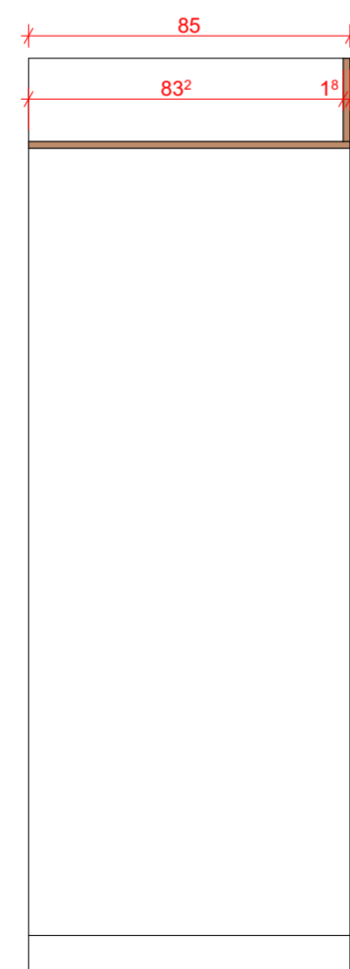

Corte H1  
Escala: 1:20

### J - ARMÁRIO

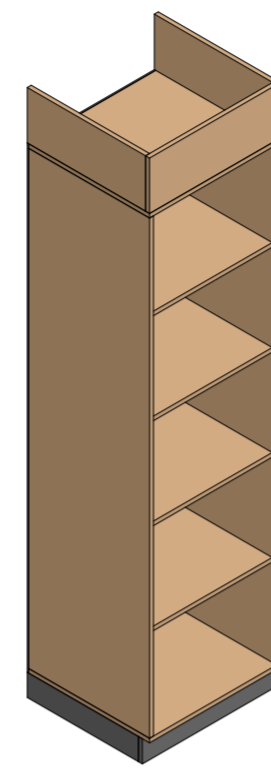

Perspectiva sem portas  
Escala: 1:30

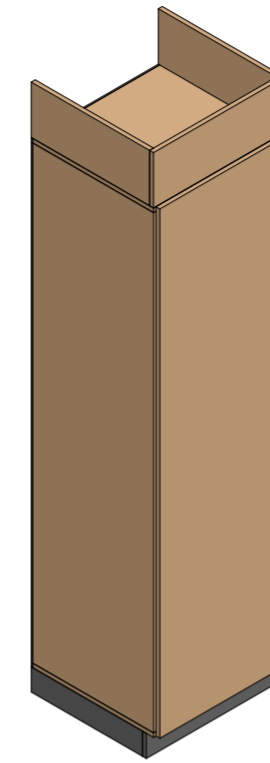

Perspectiva com portas  
Escala: 1:30

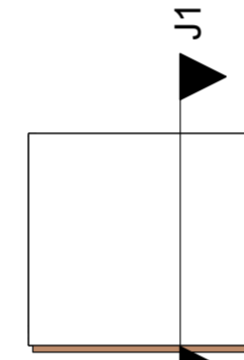

Vista J  
Vista Superior

Escala: 1:20

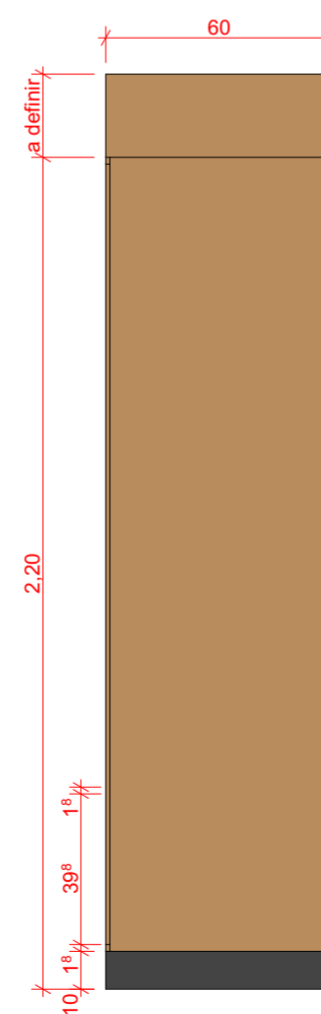

Vista J  
Escala: 1:20

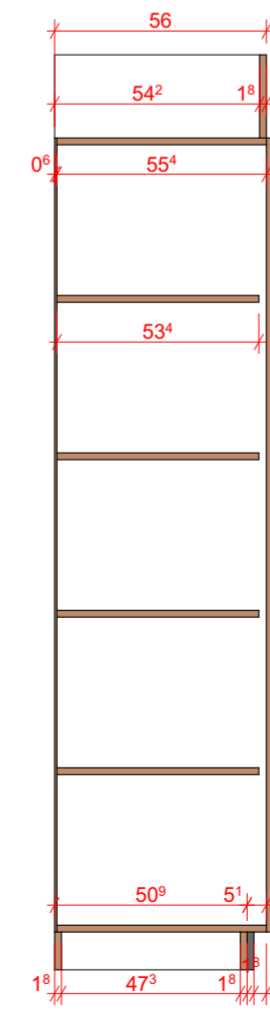

Corte J1  
Escala: 1:20

OBSERVAÇÕES:

- 1- TODA MOBÍLIA é em MDF EUCATEX PEROBA ROSA 6mm e 18mm
- 2- Soleiras de todos armários em Granito São Gabriel 10cm.
- 3- Altura da Peça de fechamento superior a depender do pé direito livre. Medir no local.



## N - ESTANTE

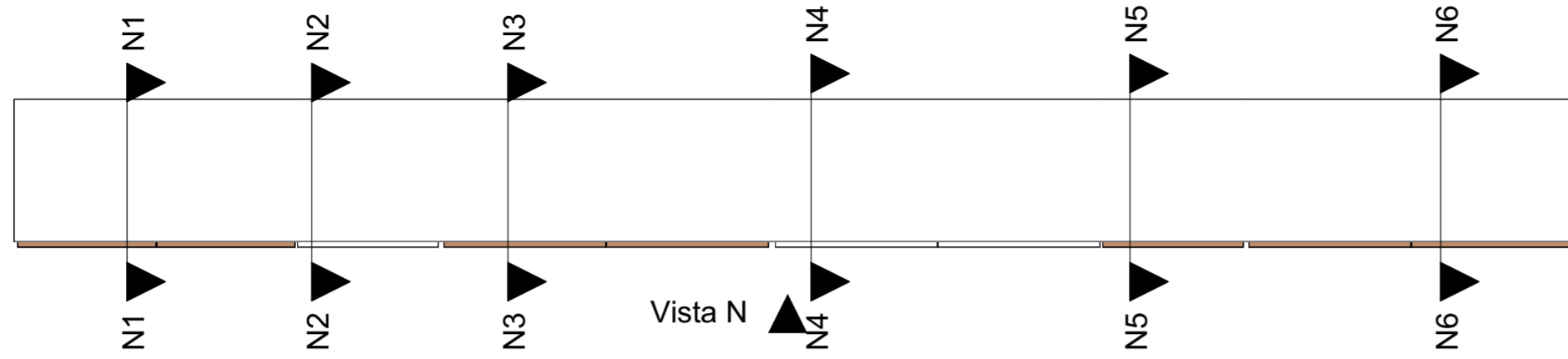

Vista Superior

Escala: 1:20

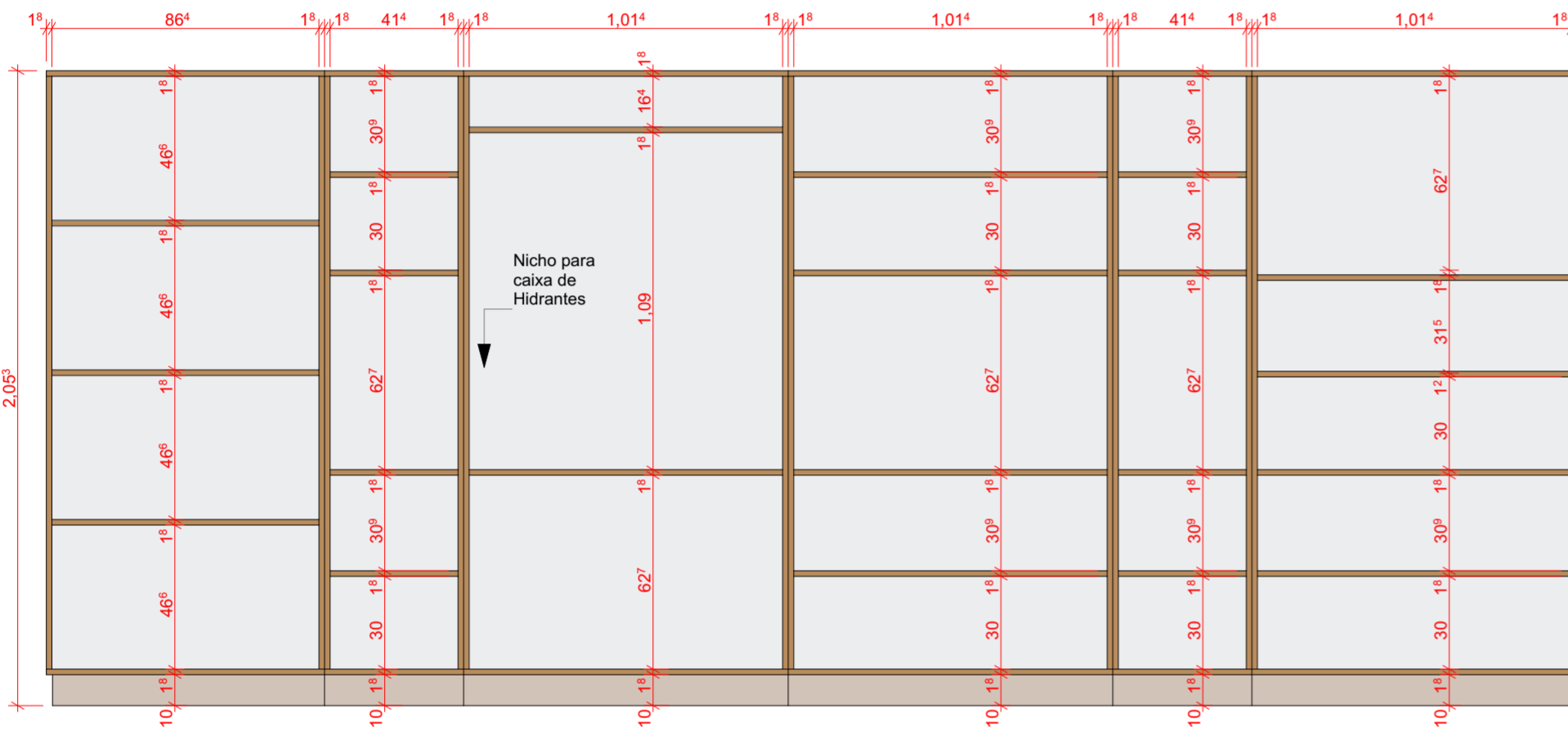

Vista N

Escala: 1:20

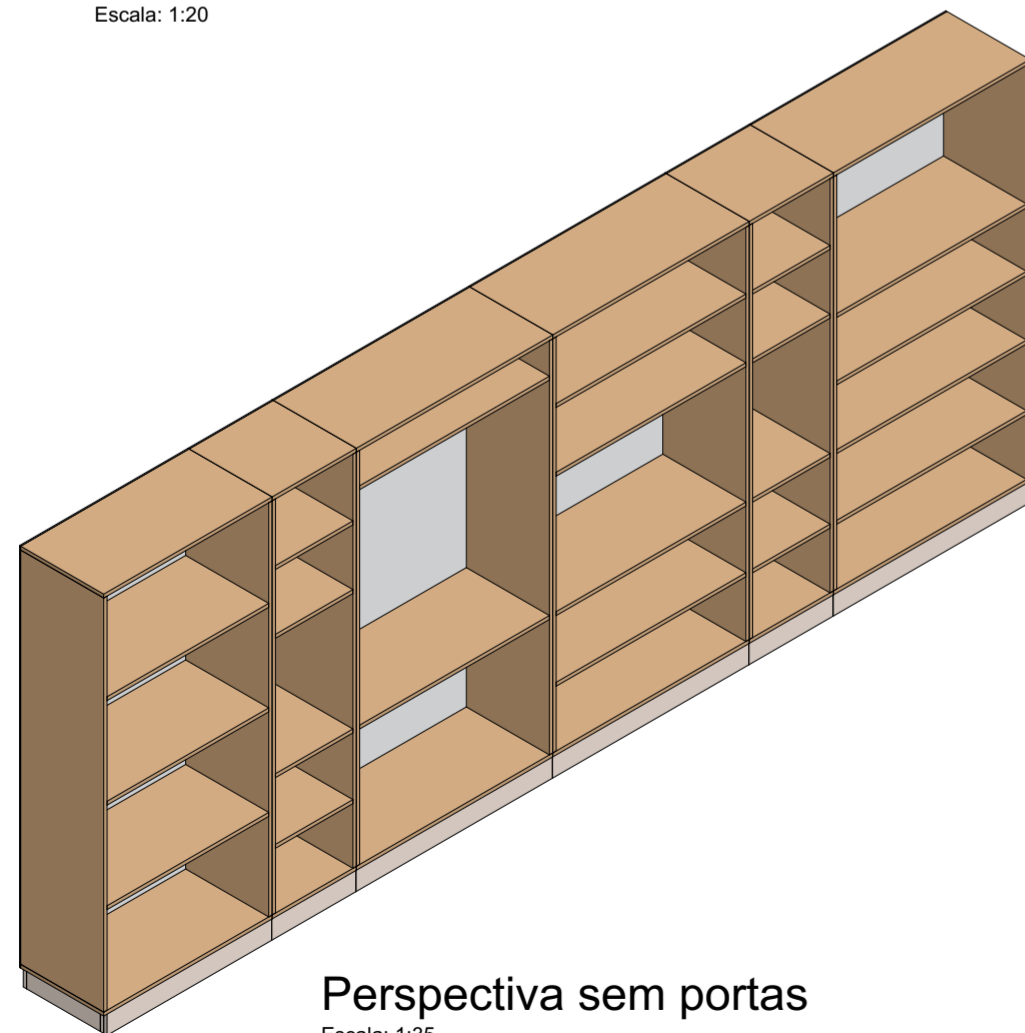

Perspectiva sem portas

Escala: 1:35

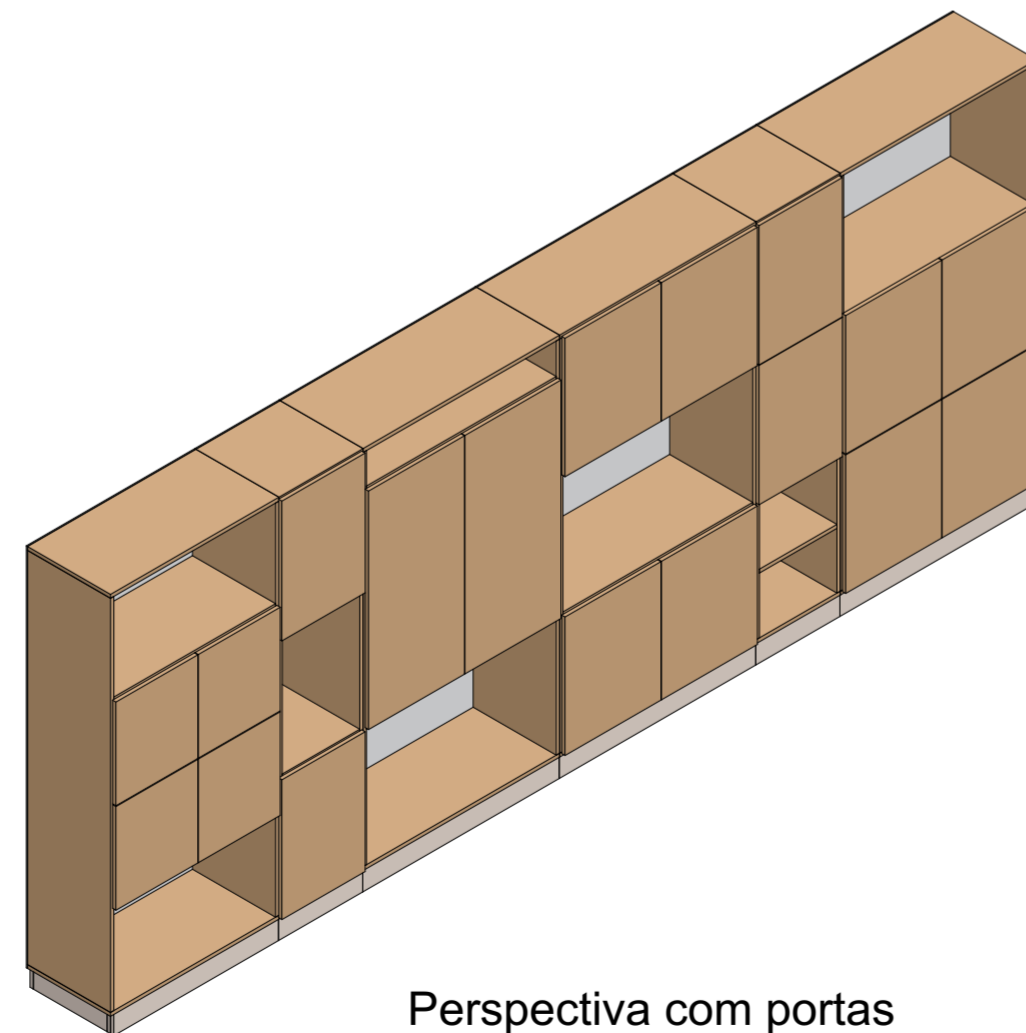

Perspectiva com portas

Escala: 1:35

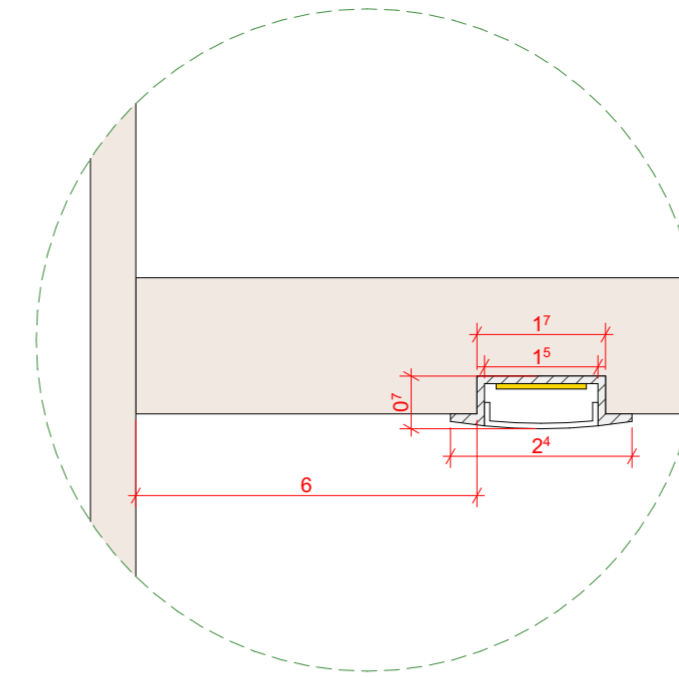

Para prateleiras Baixas

Escala: 1:1

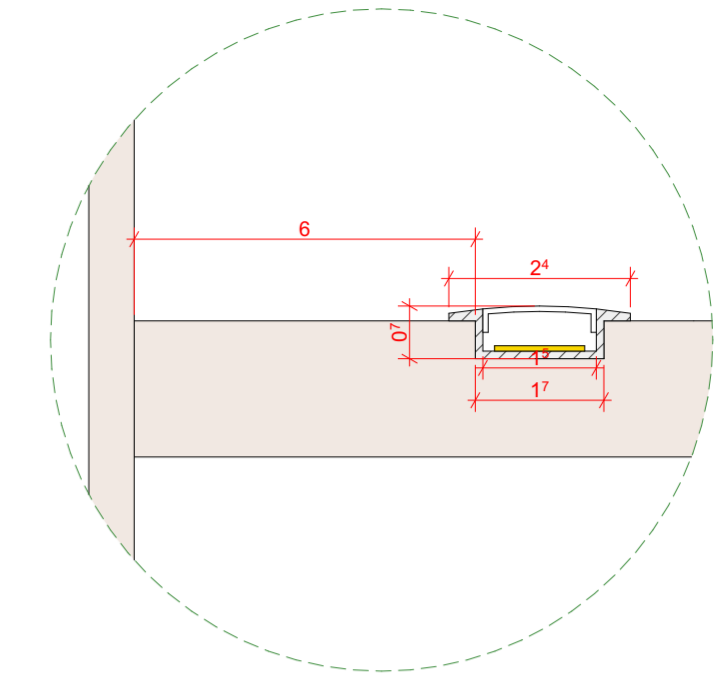

Para prateleiras Altas

Escala: 1:1

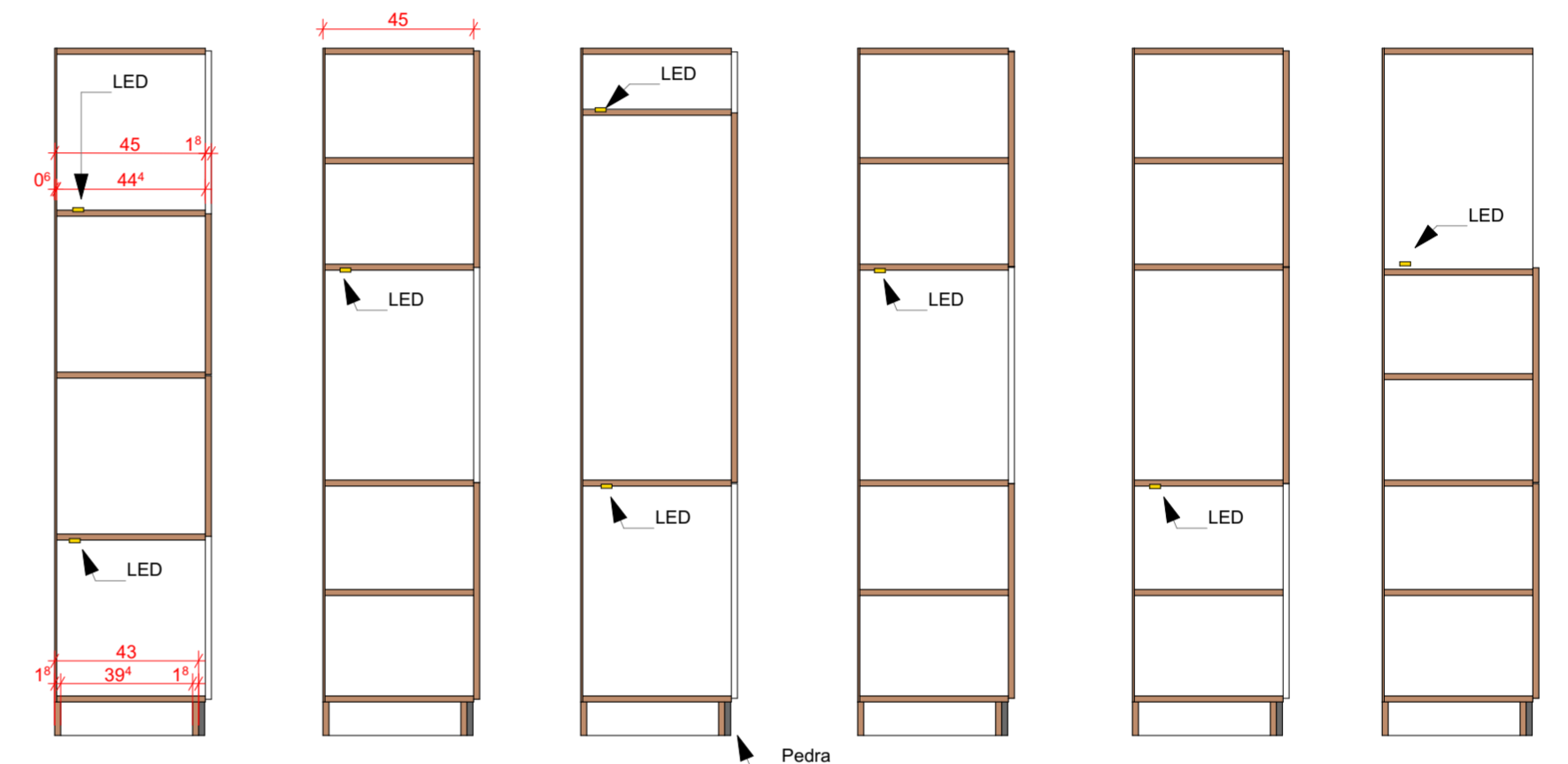

Corte N1

Escala: 1:20

Corte N2

Escala: 1:20

Corte N3

Escala: 1:20

Corte N4

Escala: 1:20

Corte N5

Escala: 1:20

Corte N6

Escala: 1:20

### OBSERVAÇÕES:

1- Armário de 18 portas e prateleiras internas com iluminação

Caixa e portas e prateleiras em MDF 18mm EUCATEX PEROBA ROSA, Fundo em MDF BRANCO TX 6mm. Puxadores tipo CAVA.

Iluminação em perfil de embutir de LED 120LED/m 3500k. Prateleiras altas fixar embaixo, Prateleiras baixas, em cima.

Não haverá Fundo no NICHOS DO HIDRANTE.

Fixar Rodapés de Pedra Granito São Gabriel nas soleiras de toda mobília.

QUADRO RESUMO DE DIMENSÕES:

DESCRIÇÃO	QTD	ÁREA (UN)	ÁREA (TOTAL)
ARMÁRIO (A/D)	2	10	20
BANCADA (C/D)	2	28	54
PASS THROUGH (E/I)	2	5	10
BEBEDOURO (F)	1	8	8
REFRIGERADOR (G)	1	6	6
REFRIGERADOR (H)	1	8	8
ARMÁRIO (J)	1	8	8
CARRINHO DE APOIO (K/L)	2	3	3
BANCADA APOIO COPA (O)	1	4	4
ESTANTE (N)	1	38	38
REVESTIMENTO DOS PILARES	6	5	30

TOTAL: 189m<sup>2</sup>







