

Planta de localização
escala 1:50

Nome	Seção (cm)	X (cm)	Y (cm)	Carga Máx. (kg)	Carga Mín. (kg)	Mx (kgf/m)	My (kgf/m)	Fx (kg)	Fy (kg)	Lado B (cm)	Fundo H (cm)	P0/Ha (cm)	ht/hb (cm)	ne	Estaca ca	Bloco Base tub. (cm)	
E1	-	20803.63	11094.24	0.7	0.5	100	100	0.1	0.1	-	-	-	-	-	1	C25	0
E2	-	20963.82	11134.75	1.0	0.8	100	100	0.1	0.1	-	-	-	-	-	1	C25	0
E3	-	21171.33	11178.89	0.9	0.8	100	100	0.1	0.1	-	-	-	-	-	1	C25	0
E4	-	21358.84	11219.04	0.9	0.8	100	100	0.1	0.1	-	-	-	-	-	1	C25	0
E5	-	21545.68	11251.07	0.9	0.8	100	100	0.1	0.1	-	-	-	-	-	1	C25	0
E6	-	21728.37	11285.21	0.9	0.8	100	100	0.1	0.1	-	-	-	-	-	1	C25	0
E7	-	21911.06	11328.35	0.9	0.8	100	100	0.1	0.1	-	-	-	-	-	1	C25	0
E8	-	22093.75	11333.49	0.9	0.8	100	100	0.1	0.1	-	-	-	-	-	1	C25	0
E9	-	22275.45	11357.57	0.8	0.7	100	100	0.1	0.1	-	-	-	-	-	1	C25	0
E10	-	22420.25	11373.71	0.7	0.6	100	100	0.1	0.1	-	-	-	-	-	1	C25	0
E11	-	22566.04	11387.57	0.7	0.6	100	100	0.1	0.1	-	-	-	-	-	1	C25	0
E12	-	22709.84	11397.57	0.8	0.6	100	100	0.1	0.1	-	-	-	-	-	1	C25	0
E13	-	22847.13	11397.57	0.8	0.4	100	100	0.1	0.1	-	-	-	-	-	1	C25	0
E14	-	21922.19	11255.09	0.9	0.8	100	100	0.1	0.1	-	-	-	-	-	1	C25	0
E15	-	22104.88	11289.22	0.9	0.8	100	100	0.1	0.1	-	-	-	-	-	1	C25	0
E16	-	22281.05	11272.57	0.8	0.6	100	100	0.1	0.1	-	-	-	-	-	1	C25	0
E17	-	22402.35	11272.57	0.7	0.6	100	100	0.1	0.1	-	-	-	-	-	1	C25	0
E18	-	22566.04	11272.57	0.7	0.6	100	100	0.1	0.1	-	-	-	-	-	1	C25	0
E19	-	22709.84	11272.57	0.8	0.6	100	100	0.1	0.1	-	-	-	-	-	1	C25	0
E20	-	22847.13	11272.57	0.7	0.5	100	100	0.1	0.1	-	-	-	-	-	1	C25	0
E21	-	21540.00	11177.31	0.9	0.7	100	100	0.1	0.1	-	-	-	-	-	1	C25	0
E22	-	21736.51	11200.95	0.9	0.8	100	100	0.1	0.1	-	-	-	-	-	1	C25	0
E23	-	22064.56	11193.70	1.1	0.9	100	100	0.1	0.1	-	-	-	-	-	1	C25	0
E24	-	22281.05	11222.57	0.9	0.7	100	100	0.1	0.1	-	-	-	-	-	1	C25	0
E25	-	22425.16	11222.57	0.7	0.6	100	100	0.1	0.1	-	-	-	-	-	1	C25	0
E26	-	22568.33	11222.57	0.7	0.6	100	100	0.1	0.1	-	-	-	-	-	1	C25	0
E27	-	22711.46	11222.57	0.8	0.6	100	100	0.1	0.1	-	-	-	-	-	1	C25	0
E28	-	22847.13	11222.57	0.5	0.3	100	100	0.1	0.1	-	-	-	-	-	1	C25	0
E29	-	21189.97	11053.97	0.9	0.8	100	100	0.1	0.1	-	-	-	-	-	1	C25	0
E30	-	21377.45	11136.11	0.9	0.8	100	100	0.1	0.1	-	-	-	-	-	1	C25	0
E31	-	21848.09	11184.89	0.8	0.6	100	100	0.1	0.1	-	-	-	-	-	1	C25	0
E32	-	20822.07	11011.32	0.7	0.5	100	100	0.1	0.1	-	-	-	-	-	1	C25	0
E33	-	21022.46	11051.82	1.0	0.8	100	100	0.1	0.1	-	-	-	-	-	1	C25	0

Simbologia	Nome	q (cm)	Quantidade
	C25	25.00	33

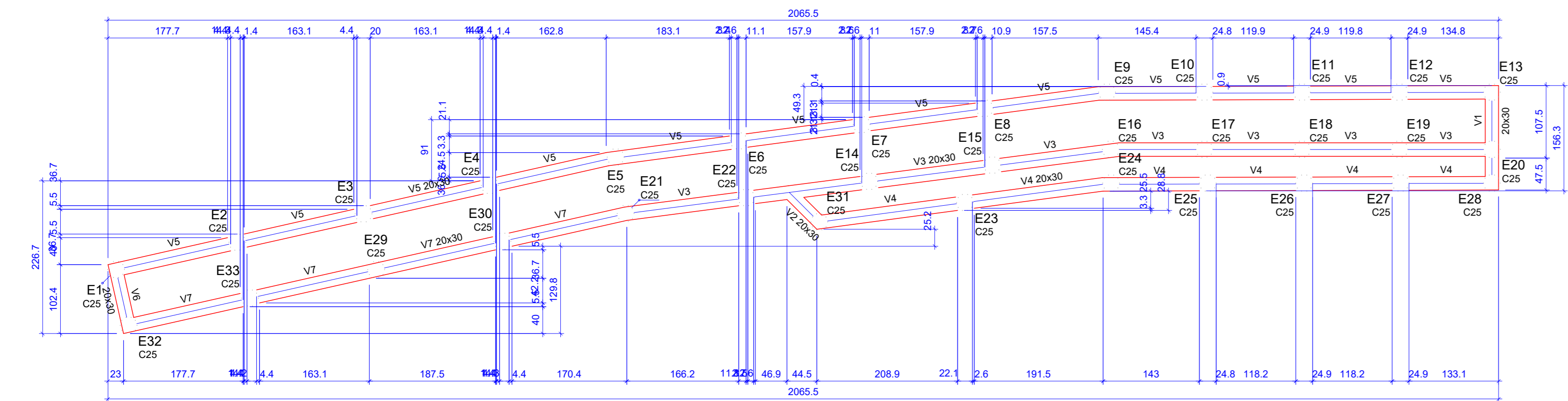
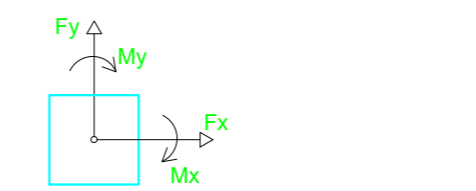
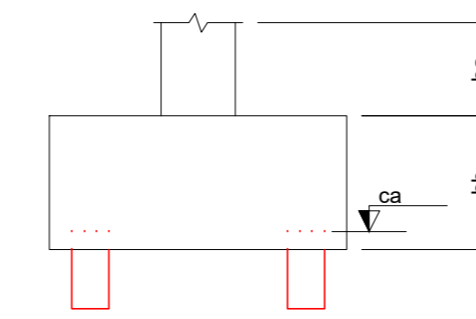

Forma do pavimento BALDRAME (Nível 0)
escala 1:50

Nome	Seção (cm)	Elevação (cm)	Nível (cm)
V1	20x30	0	0
V2	20x30	0	0
V3	20x30	0	0
V4	20x30	0	0
V5	20x30	0	0
V7	20x30	0	0

Características dos materiais	fck (kgf/cm²)	Ecs (kgf/cm²)
	25.0	24.1500

Nome	Seção (cm)	Elevação (cm)	Nível (cm)
P1	14	0	0
P2	14	0	0
P3	14	0	0
P4	14	0	0
P5	14	0	0
P6	14	0	0
P7	14	0	0
P8	14	0	0
P9	14	0	0
P10	14	0	0
P11	14	0	0
P12	14	0	0
P13	14	0	0
P14	14	0	0
P15	14	0	0
P16	14	0	0
P17	14	0	0
P18	14	0	0
P19	14	0	0
P20	14	0	0
P21	14	0	0
P22	14	0	0
P23	14	0	0
P24	14	0	0
P25	14	0	0
P26	14	0	0
P27	14	0	0
P28	14	0	0
P29	14	0	0
P30	14	0	0
P31	14	0	0
P32	14	0	0
P33	14	0	0
P34	14	0	0
P35	14	0	0
P36	14	0	0
P37	14	0	0
P38	14	0	0
P39	14	0	0
P40	14	0	0
P41	14	0	0
P42	14	0	0
P43	14	0	0
P44	14	0	0
P45	14	0	0
P46	14	0	0
P47	14	0	0
P48	14	0	0
P49	14	0	0
P50	14	0	0
P51	14	0	0
P52	14	0	0
P53	14	0	0
P54	14	0	0
P55	14	0	0
P56	14	0	0
P57	14	0	0
P58	14	0	0
P59	14	0	0
P60	14	0	0
P61	14	0	0
P62	14	0	0
P63	14	0	0
P64	14	0	0
P65	14	0	0
P66	14	0	0
P67	14	0	0
P68	14	0	0
P69	14	0	0
P70	14	0	0
P71	14	0	0
P72	14	0	0
P73	14	0	0
P74	14	0	0
P75	14	0	0
P76	14	0	0
P77	14	0	0
P78	14	0	0
P79	14	0	0
P80	14	0	0
P81	14	0	0
P82	14	0	0
P83	14	0	0
P84	14	0	0
P85	14	0	0
P86	14	0	0
P87	14	0	0
P88	14	0	0
P89	14	0	0
P90	14	0	0
P91	14	0	0
P92	14	0	0
P93	14	0	0
P94	14	0	0
P95	14	0	0
P96	14	0	0
P97	14	0	0
P98	14	0	0
P99	14	0	0
P100	14	0	0

Nome	Seção (cm)	Elevação (cm)	Nível (cm)
P1	14	0	0
P2	14	0	0
P3	14	0	0
P4	14	0	0
P5	14	0	0
P6	14	0	0
P7	14	0	0
P8	14	0	0
P9	14	0	0
P10	14	0	0
P11	14	0	0
P12	14	0	0
P13	14	0	0
P14	14	0	0
P15	14	0	0
P16	14	0	0
P17	14	0	0
P18	14	0	0
P19	14	0	0
P20	14	0	0
P21	14	0	0
P22	14	0	0
P23	14	0	0
P24	14	0	0
P25	14	0	0
P26	14	0	0
P27	14	0	0
P28	14	0	0
P29	14	0	0
P30	14	0	0
P31	14	0	0
P32	14	0	0
P33	14	0	0
P34	14	0	0
P35	14	0	0
P36	14	0	0
P37	14	0	0
P38	14	0	0
P39	14	0	0
P40	14	0	0
P41	14	0	0
P42	14	0	0
P43	14	0	0
P44	14	0	0
P45	14	0	0
P46	14	0	0
P47	14	0	0
P48	14	0	0
P49	14	0	0
P50	14	0	0
P51	14	0	0
P52	14	0	0
P53	14	0	0
P54	14	0	0
P55	14	0	0
P56	14	0	0
P57	14	0	0
P58	14	0	0
P59	14	0	0
P60	14	0	0
P61	14	0	0
P62	14	0	0
P63	14	0	0
P64	14	0	0
P65	14	0	0
P66	14	0	0
P67	14	0	0
P68	14	0	0
P69	14	0	0
P70	14	0	0
P71	14	0	0
P72	14	0	0
P73	14	0	0
P74	14	0	0
P75	14	0	0
P76	14	0	0
P77	14	0	0
P78	14	0	0
P79	14	0	0
P80	14	0	0
P81	14	0	0
P82	14	0	0
P83	14	0	0
P84	14	0	0
P85	14	0	0
P86	14	0	0
P87	14	0	0
P88	14	0	0
P89	14	0	0
P90	14	0	0
P91	14	0	0
P92	14	0	0
P93	14	0	0
P94	14	0	0
P95	14	0	0
P96	14	0	0
P97	14	0	0
P98	14	0	0
P99	14	0	0
P100	14	0	0

Nome	Seção (cm)	Elevação (cm)	Nível (cm)
P1	14	0	0
P2	14	0	0
P3	14	0	0
P4	14	0	0
P5	14		