

PLANTA

 Área a ser adequada

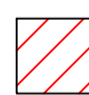
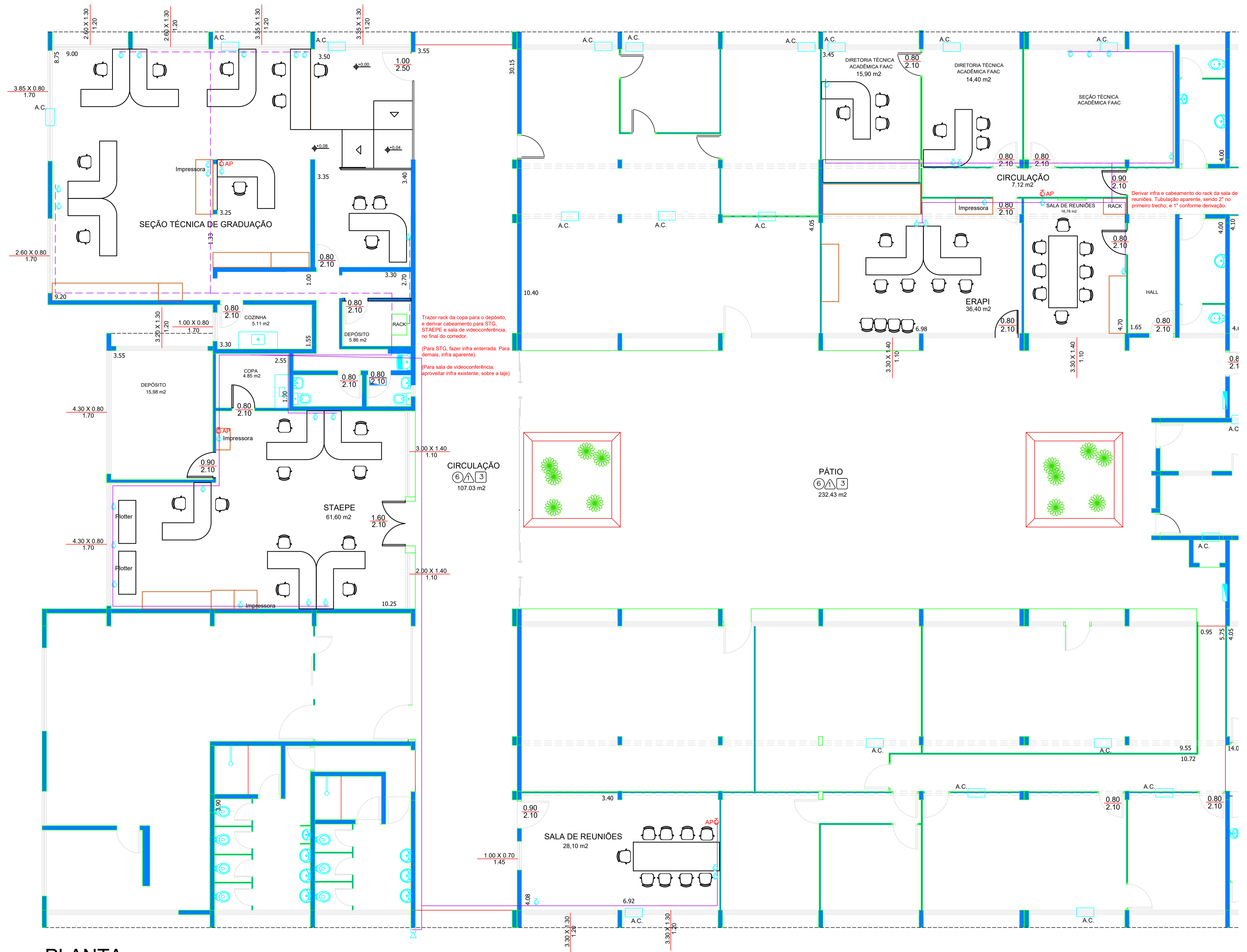

PLANTA

## LEGENDA

	ELETRODUTO DE LÓGICA Ø1" (QUANDO NÃO INDICADO) - APARENTE
	ELETRODUTO DE LÓGICA Ø1" (QUANDO NÃO INDICADO) - EMBUTIDO NO PISO
	PTO LOGICA RJ45 CAT 6 PLACA 4X2 H=0.50M (QDO NÃO INDICADO)
	CJ 02 PTOS LOGICA RJ45 CAT 6 PLACA 4X4 H=0.50M (QDO NÃO INDICADO)
	AP - WI FI - CX 4X2 RJ 45 CAT 6 h=2.50M
	POTO CAM - CX 4X2 RJ 45 CAT 6 h=2.50M

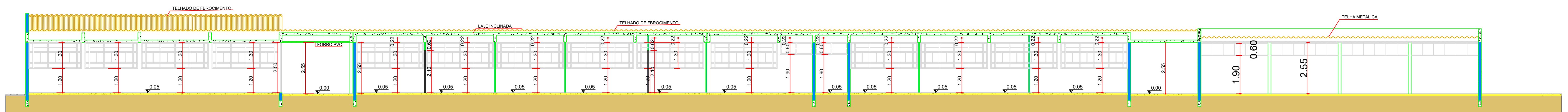

CORTE AA

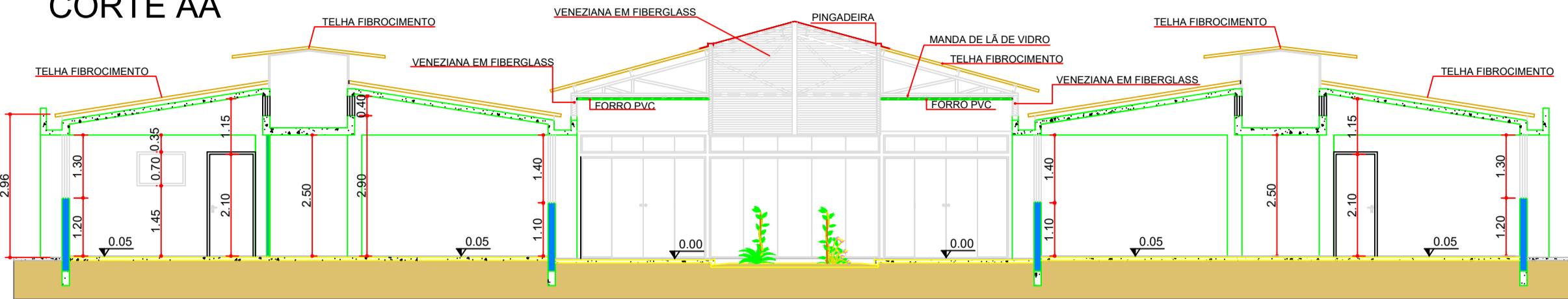

CORTE BB

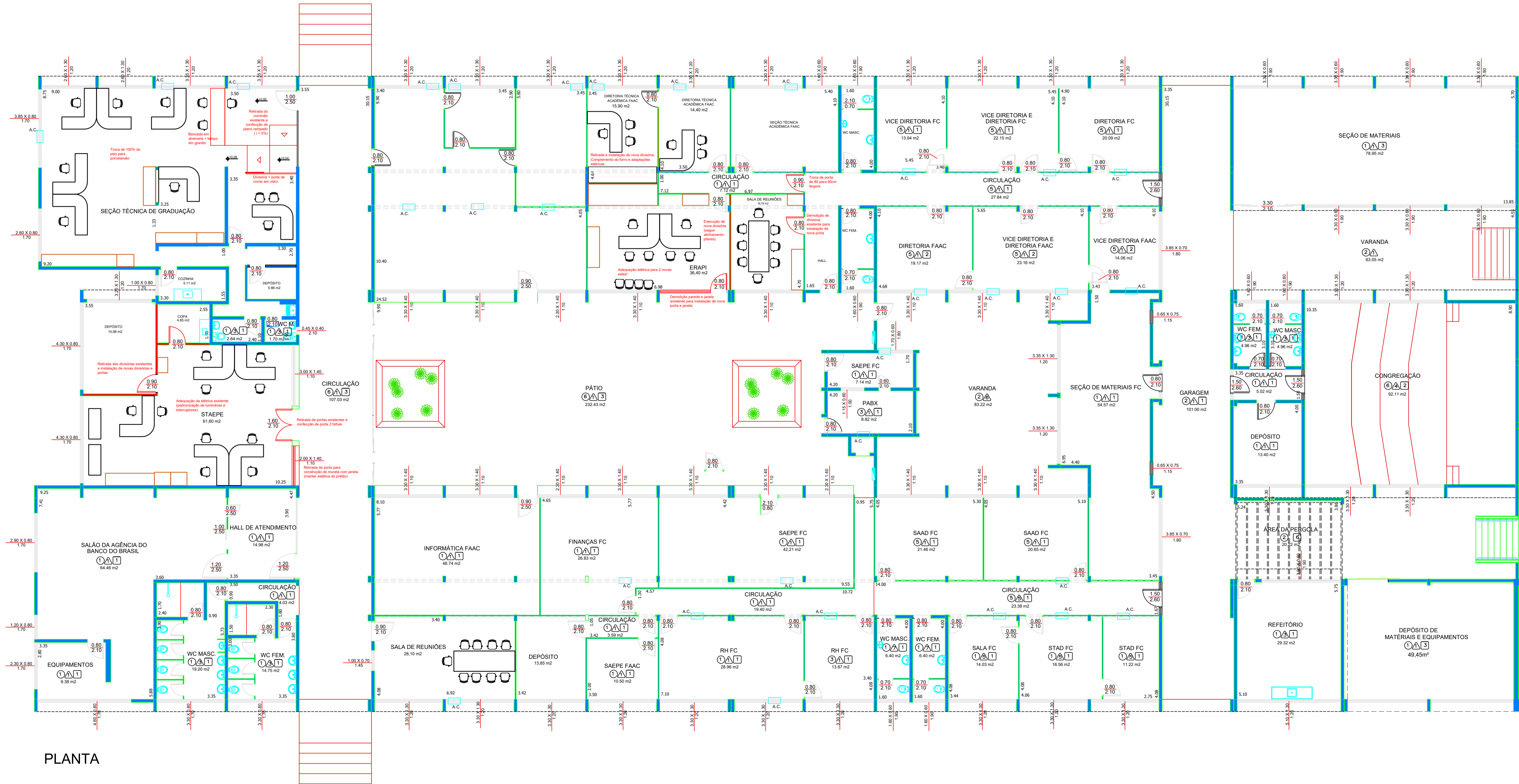

PLANTA

LEGENDA

- Demolir / Retirar
- Construir

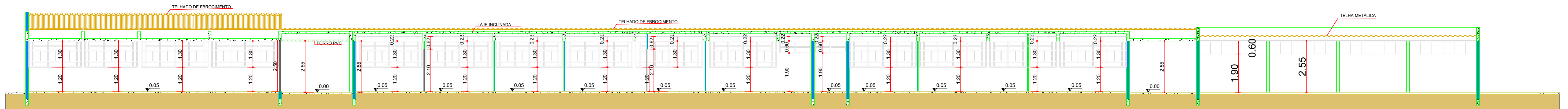

CORTE AA

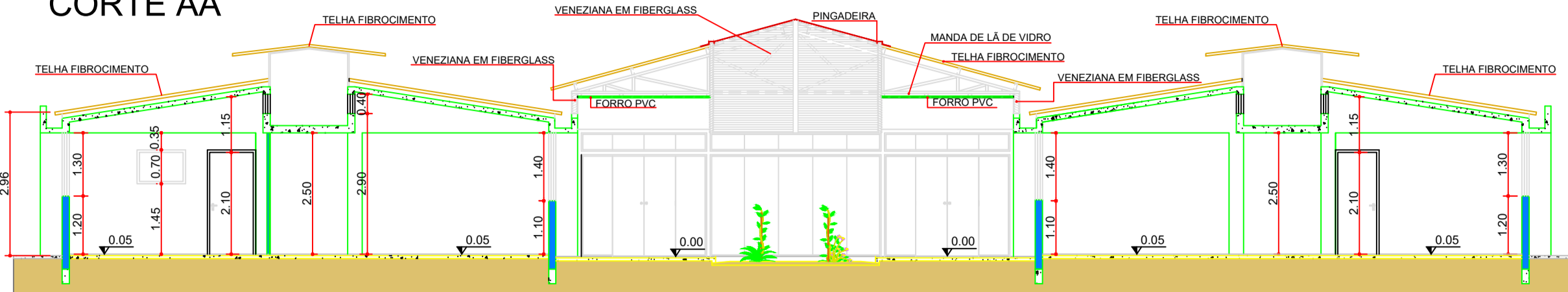

CORTE BB

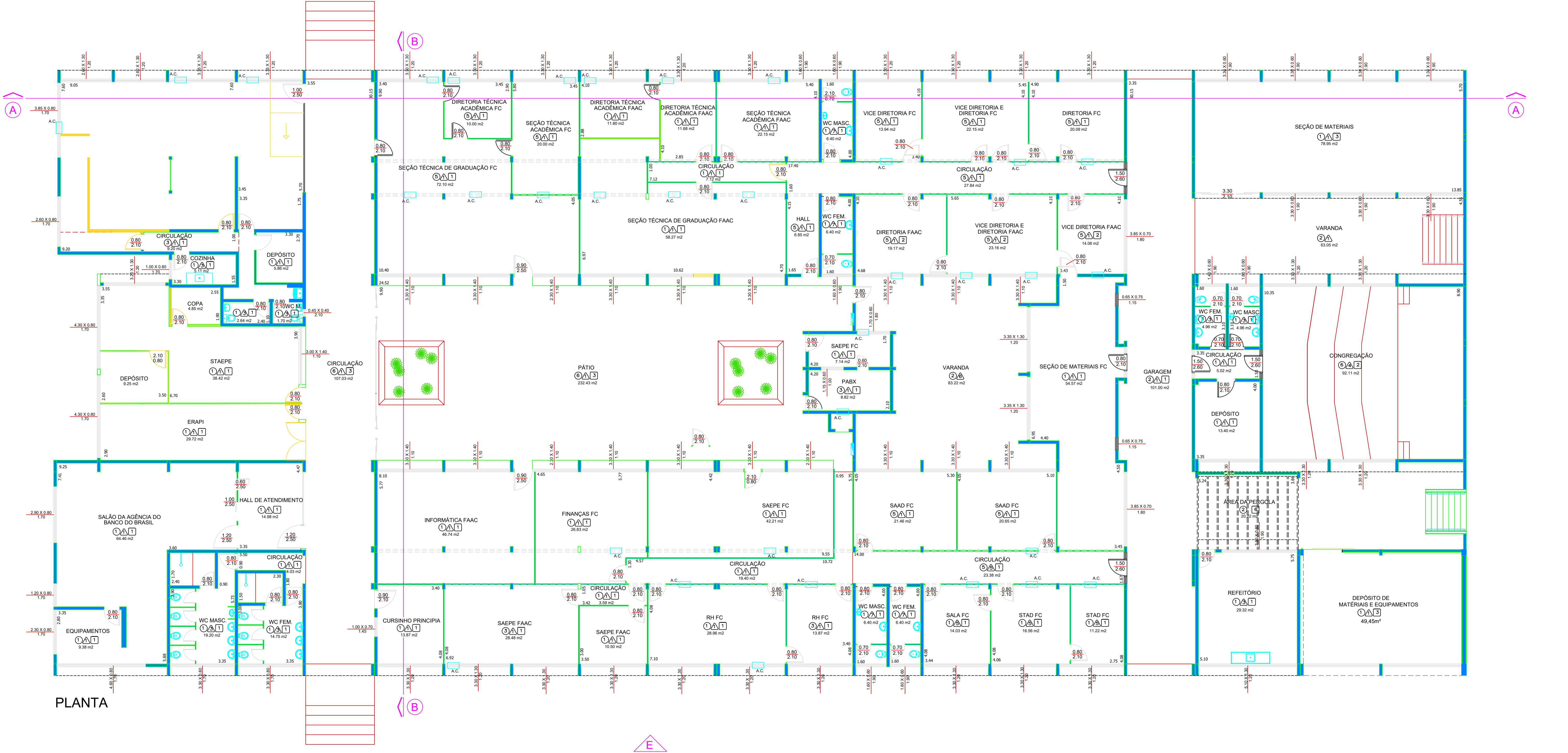

PLANTA

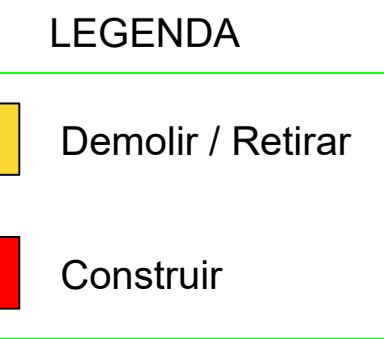



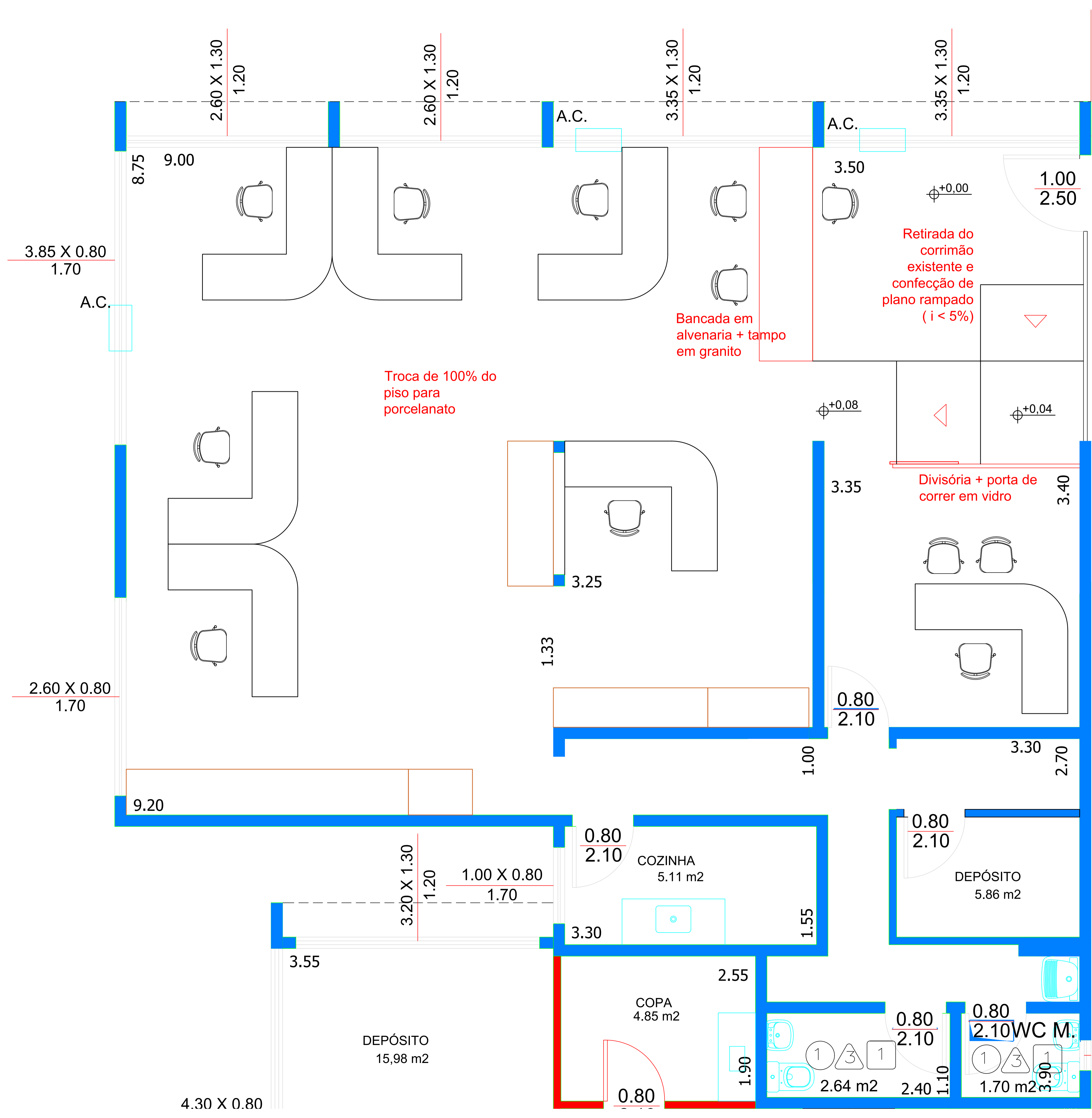

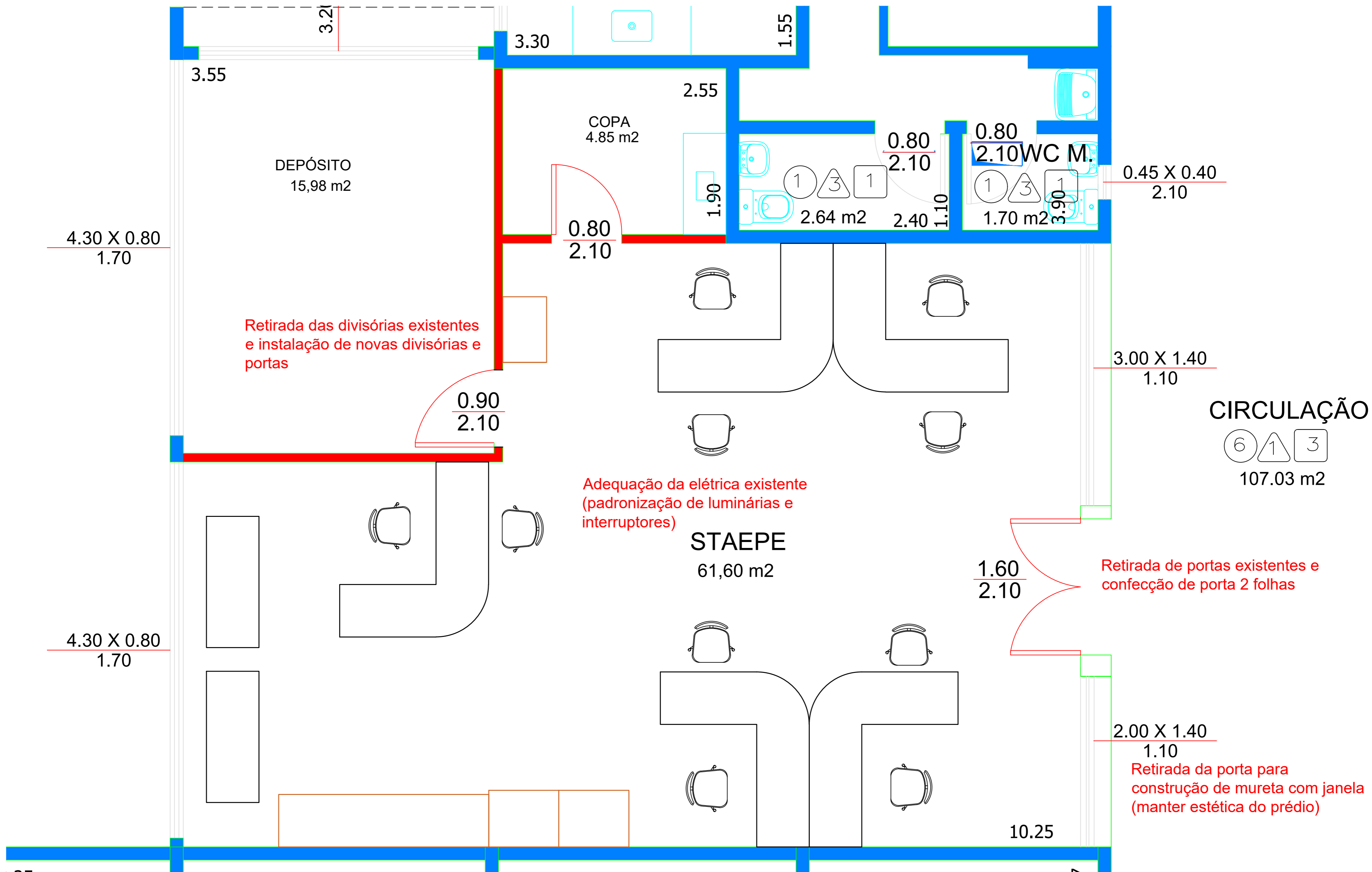

3.21

3.55

3.30

1.55

2.55

COPA  
4.85 m<sup>2</sup>

DEPÓSITO  
15,98 m<sup>2</sup>

4.30 X 0.80  
1.70

Retirada das divisórias existentes e instalação de novas divisórias e portas

0.80  
2.10

1.90

1 3 1

2.64 m<sup>2</sup>

0.80  
2.10

0.80  
2.10

1.70 m<sup>2</sup>

0.45 X 0.40  
2.10

3.00 X 1.40  
1.10

CIRCULAÇÃO

6 1 3

107.03 m<sup>2</sup>

Adequação da elétrica existente (padronização de luminárias e interruptores)

STAEPE  
61,60 m<sup>2</sup>

1.60  
2.10

Retirada de portas existentes e confecção de porta 2 folhas

4.30 X 0.80  
1.70

2.00 X 1.40  
1.10

Retirada da porta para construção de mureta com janela (manter estética do prédio)

10.25

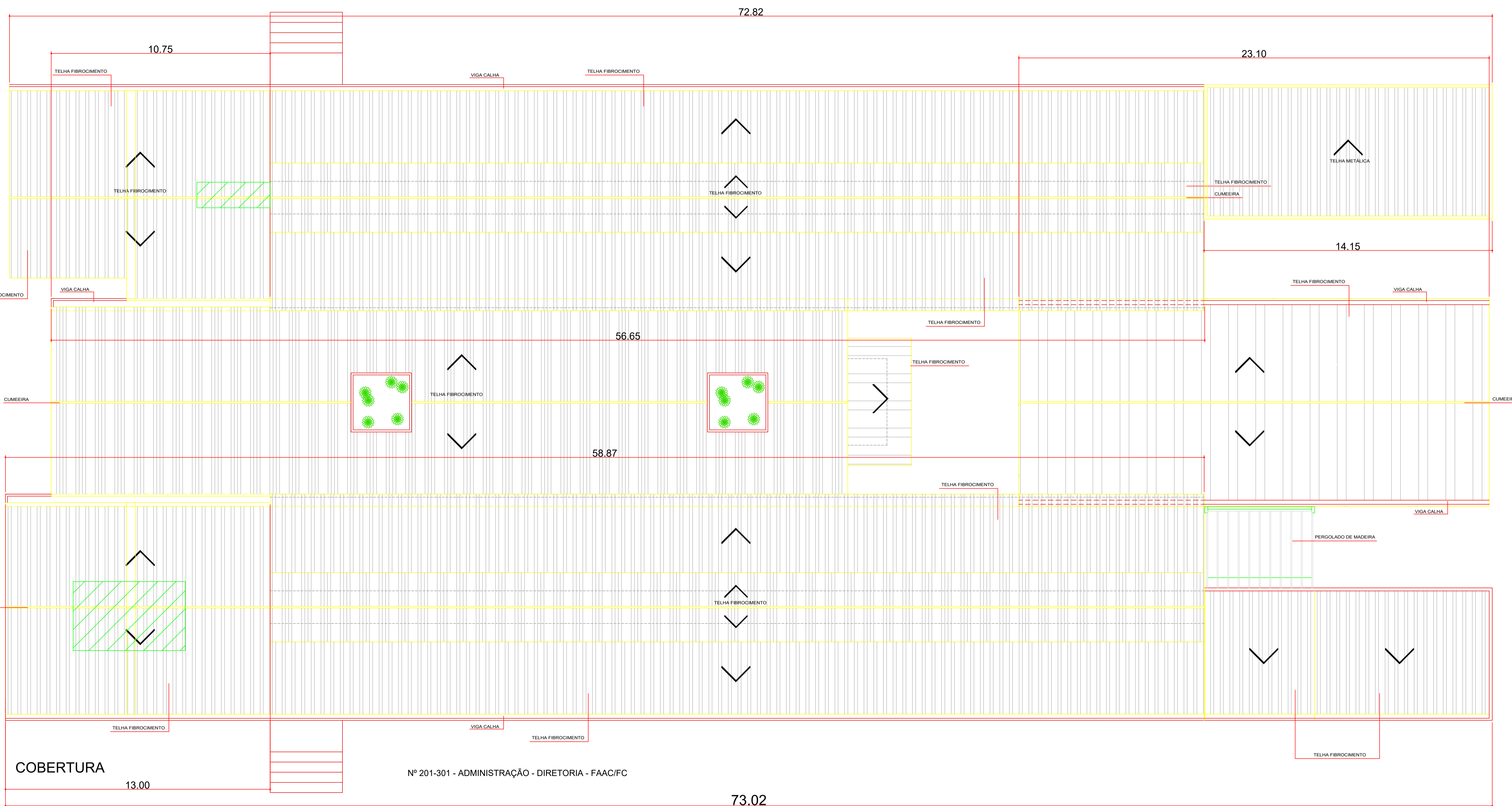

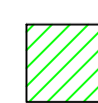
 Área a ser adequada

## ANEXO 1:

**Pasta Google drive contendo documentação relacionada aos projetos:**

[https://drive.google.com/drive/folders/1eX\\_q6JCiJXMONixGbwQGfepYK5t2p7wY?usp=sharing](https://drive.google.com/drive/folders/1eX_q6JCiJXMONixGbwQGfepYK5t2p7wY?usp=sharing)