

QUADRO GERAL DE CARGAS

REFERENCIA	PILAR	OU	ESTACA	ESTACA	ESTACA	ESTACA	ESTACA	ESTACA	ESTACA
entre P08 e P09	EM1	EM2	EM3	EM1	EM2	EM3	EM1	EM2	EM3
entre P08 e P09	10,0	12,0	20,0	12,0	20,0	24,0	12,0	20,0	18,0
entre P09 e P10	10,0	12,0	20,0	12,0	20,0	24,0	12,0	20,0	18,0
entre P10 e P11	10,0	12,0	20,0	12,0	20,0	24,0	12,0	20,0	18,0
entre P11 e P12	10,0	12,0	20,0	12,0	20,0	24,0	12,0	20,0	18,0
entre P12 e P13	10,0	12,0	20,0	12,0	20,0	24,0	12,0	20,0	18,0
entre P13 e P14	10,0	12,0	20,0	12,0	20,0	24,0	12,0	20,0	18,0
entre P14 e P15	10,0	12,0	20,0	12,0	20,0	24,0	12,0	20,0	18,0
entre P15 e P16	10,0	12,0	20,0	12,0	20,0	24,0	12,0	20,0	18,0
entre P16 e P17	10,0	12,0	20,0	12,0	20,0	24,0	12,0	20,0	18,0
entre P17 e P18	10,0	12,0	20,0	12,0	20,0	24,0	12,0	20,0	18,0
entre P18 e P19	10,0	12,0	20,0	12,0	20,0	24,0	12,0	20,0	18,0
entre P19 e P20	10,0	12,0	20,0	12,0	20,0	24,0	12,0	20,0	18,0
entre P20 e P21	10,0	12,0	20,0	12,0	20,0	24,0	12,0	20,0	18,0
entre P21 e P22	10,0	12,0	20,0	12,0	20,0	24,0	12,0	20,0	18,0
entre P22 e P23	10,0	12,0	20,0	12,0	20,0	24,0	12,0	20,0	18,0
entre P23 e P24	10,0	12,0	20,0	12,0	20,0	24,0	12,0	20,0	18,0
entre P24 e P25	10,0	12,0	20,0	12,0	20,0	24,0	12,0	20,0	18,0
entre P25 e P26	10,0	12,0	20,0	12,0	20,0	24,0	12,0	20,0	18,0
entre P26 e P27	10,0	12,0	20,0	12,0	20,0	24,0	12,0	20,0	18,0
entre P27 e P28	10,0	12,0	20,0	12,0	20,0	24,0	12,0	20,0	18,0
entre P28 e P29	10,0	12,0	20,0	12,0	20,0	24,0	12,0	20,0	18,0
entre P29 e P30	10,0	12,0	20,0	12,0	20,0	24,0	12,0	20,0	18,0
entre P30 e P31	10,0	12,0	20,0	12,0	20,0	24,0	12,0	20,0	18,0
entre P31 e P32	10,0	12,0	20,0	12,0	20,0	24,0	12,0	20,0	18,0
entre P32 e P33	10,0	12,0	20,0	12,0	20,0	24,0	12,0	20,0	18,0
entre P33 e P34	10,0	12,0	20,0	12,0	20,0	24,0	12,0	20,0	18,0
entre P34 e P35	10,0	12,0	20,0	12,0	20,0	24,0	12,0	20,0	18,0
entre P35 e P36	10,0	12,0	20,0	12,0	20,0	24,0	12,0	20,0	18,0
entre P36 e P37	10,0	12,0	20,0	12,0	20,0	24,0	12,0	20,0	18,0
entre P37 e P38	10,0	12,0	20,0	12,0	20,0	24,0	12,0	20,0	18,0
entre P38 e P39	10,0	12,0	20,0	12,0	20,0	24,0	12,0	20,0	18,0
entre P39 e P40	10,0	12,0	20,0	12,0	20,0	24,0	12,0	20,0	18,0
entre P40 e P41	10,0	12,0	20,0	12,0	20,0	24,0	12,0	20,0	18,0
entre P41 e P42	10,0	12,0	20,0	12,0	20,0	24,0	12,0	20,0	18,0
entre P42 e P43	10,0	12,0	20,0	12,0	20,0	24,0	12,0	20,0	18,0
entre P43 e P44	10,0	12,0	20,0	12,0	20,0	24,0	12,0	20,0	18,0
entre P44 e P45	10,0	12,0	20,0	12,0	20,0	24,0	12,0	20,0	18,0
entre P45 e P46	10,0	12,0	20,0	12,0	20,0	24,0	12,0	20,0	18,0
entre P46 e P47	10,0	12,0	20,0	12,0	20,0	24,0	12,0	20,0	18,0
entre P47 e P48	10,0	12,0	20,0	12,0	20,0	24,0	12,0	20,0	18,0
entre P48 e P49	10,0	12,0	20,0	12,0	20,0	24,0	12,0	20,0	18,0
entre P49 e P50	10,0	12,0	20,0	12,0	20,0	24,0	12,0	20,0	18,0
entre P50 e P51	10,0	12,0	20,0	12,0	20,0	24,0	12,0	20,0	18,0
entre P51 e P52	10,0	12,0	20,0	12,0	20,0	24,0	12,0	20,0	18,0
entre P52 e P53	10,0	12,0	20,0	12,0	20,0	24,0	12,0	20,0	18,0
entre P53 e P54	10,0	12,0	20,0	12,0	20,0	24,0	12,0	20,0	18,0
entre P54 e P55	10,0	12,0	20,0	12,0	20,0	24,0	12,0	20,0	18,0
entre P55 e P56	10,0	12,0	20,0	12,0	20,0	24,0	12,0	20,0	18,0
entre P56 e P57	10,0	12,0	20,0	12,0	20,0	24,0	12,0	20,0	18,0
entre P57 e P58	10,0	12,0	20,0	12,0	20,0	24,0	12,0	20,0	18,0
entre P58 e P59	10,0	12,0	20,0	12,0	20,0	24,0	12,0	20,0	18,0
entre P59 e P60	10,0	12,0	20,0	12,0	20,0	24,0	12,0	20,0	18,0
entre P60 e P61	10,0	12,0	20,0	12,0	20,0	24,0	12,0	20,0	18,0
entre P61 e P62	10,0	12,0	20,0	12,0	20,0	24,0	12,0	20,0	18,0
entre P62 e P63	10,0	12,0	20,0	12,0	20,0	24,0	12,0	20,0	18,0
entre P63 e P64	10,0	12,0	20,0	12,0	20,0	24,0	12,0	20,0	18,0
entre P64 e P65	10,0	12,0	20,0	12,0	20,0	24,0	12,0	20,0	18,0
entre P65 e P66	10,0	12,0	20,0	12,0	20,0	24,0	12,0	20,0	18,0
entre P66 e P67	10,0	12,0	20,0	12,0	20,0	24,0	12,0	20,0	18,0
entre P67 e P68	10,0	12,0	20,0	12,0	20,0	24,0	12,0	20,0	18,0
entre P68 e P69	10,0	12,0	20,0	12,0	20,0	24,0	12,0	20,0	18,0
entre P69 e P70	10,0	12,0	20,0	12,0	20,0	24,0	12,0	20,0	18,0
entre P70 e P71	10,0	12,0	20,0	12,0	20,0	24,0	12,0	20,0	18,0
entre P71 e P72	10,0	12,0	20,0	12,0	20,0	24,0	12,0	20,0	18,0
entre P72 e P73	10,0	12,0	20,0	12,0	20,0	24,0	12,0	20,0	18,0
entre P73 e P74	10,0	12,0	20,0	12,0	20,0	24,0	12,0	20,0	18,0
entre P74 e P75	10,0	12,0	20,0	12,0	20,0	24,0	12,0	20,0	18,0
entre P75 e P76	10,0	12,0	20,0	12,0	20,0	24,0	12,0	20,0	18,0
entre P76 e P77	10,0	12,0	20,0	12,0	20,0	24,0	12,0	20,0	18,0
entre P77 e P78	10,0	12,0	20,0	12,0	20,0	24,0	12,0	20,0	18,0
entre P78 e P79	10,0	12,0	20,0	12,0	20,0	24,0	12,0	20,0	18,0
entre P79 e P80	10,0	12,0	20,0	12,0	20,0	24,0	12,0	20,0	18,0
entre P80 e P81	10,0	12,0	20,0	12,0	20,0	24,0	12,0	20,0	18,0
entre P81 e P82	10,0	12,0	20,0	12,0	20,0	24,0	12,0	20,0	18,0
entre P82 e P83	10,0	12,0	20,0	12,0	20,0	24,0	12,0	20,0	18,0
entre P83 e P84	10,0	12,0	20,0	12,0	20,0	24,0	12,0	20,0	18,0
entre P84 e P85	10,0	12,0	20,0	12,0	20,0	24,0	12,0	20,0	18,0
entre P85 e P86	10,0	12,0	20,0	12,0	20,0	24,0	12,0	20,0	18,0
entre P86 e P87	10,0	12,0	20,0	12,0	20,0	24,0	12,0	20,0	18,0
entre P87 e P88	10,0	12,0	20,0	12,0	20,0	24,0	12,0	20,0	18,0
entre P88 e P89	10,0	12,0	20,0	12,0	20,0	24,0	12,0	20,0	18,0
entre P89 e P90	10,0	12,0	20,0	12,0	20,0	24,0	12,0	20,0	18,0
entre P90 e P91	10,0	12,0	20,0	12,0	20,0	24,0	12,0	20,0	18,0
entre P91 e P92	10,0	12,0	20,0	12,0	20,0	24,0	12,0	20,0	18,0
entre P92 e P93	10,0	12,0	20,0	12,0	20,0	24,0	12,0	20,0	18,0
entre P93 e P94	10,0	12,0	20,0	12,0	20,0	24,0	12,0	20,0	18,0
entre P94 e P95	10,0	12,0	20,0	12,0	20,0	24,0	12,0	20,0	18,0
entre P95 e P96	10,0	12,0	20,0	12,0	20,0	24,0	12,0	20,0	18,0
entre P96 e P97	10,0	12,0	20,0	12,0	20,0	24,0	12,0	20,0	18,0
entre P97 e P98	10,0	12,0	20,0	12,0	20,0	24,0	12,0	20,0	18,0
entre P98 e P99	10,0	12,0	20,0	12,0	20,0	24,0	12,0	20,0	18,0
entre P99 e P100	10,0	12,0	20,0	12,0	20,0	24,0	12,0	20,0	18,0

OBSERVAÇÕES QUADRO GERAL:

- Elemento considerado
- PILARES
- Numeração
- Seção transversal
- Carga majorada em 20% para cobrir recalques e distorções estruturais em 1
- Seção transversal da estaca em mm
- Carga de trabalho atuante, isto é, parcela da carga majorada do pilar incidente na estaca em 1
- Carga de trabalho atuante, isto é, parcela da carga majorada do pilar incidente na estaca em 1
- Carga geotécnica admissível, como serviço, multiplicada de carga estimada por Dinitol-Quarentena em 1
- Carga de combinação e a carga normalizada com F₁=1,5 em 1

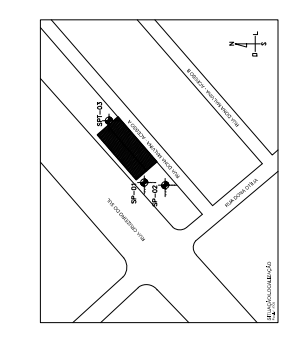
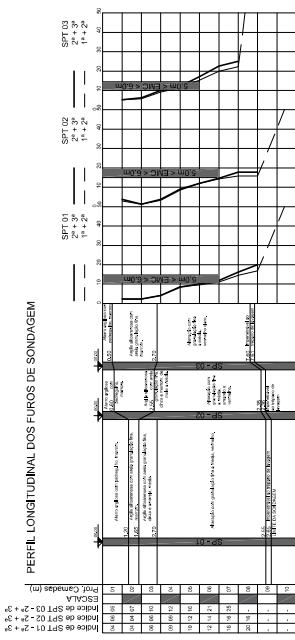

- PILOS QUE HAZER NO PAVIMENTO**
- PILAS QUE HAZER NA CONTRA
- PILAS QUE HAZER NO PAVIMENTO

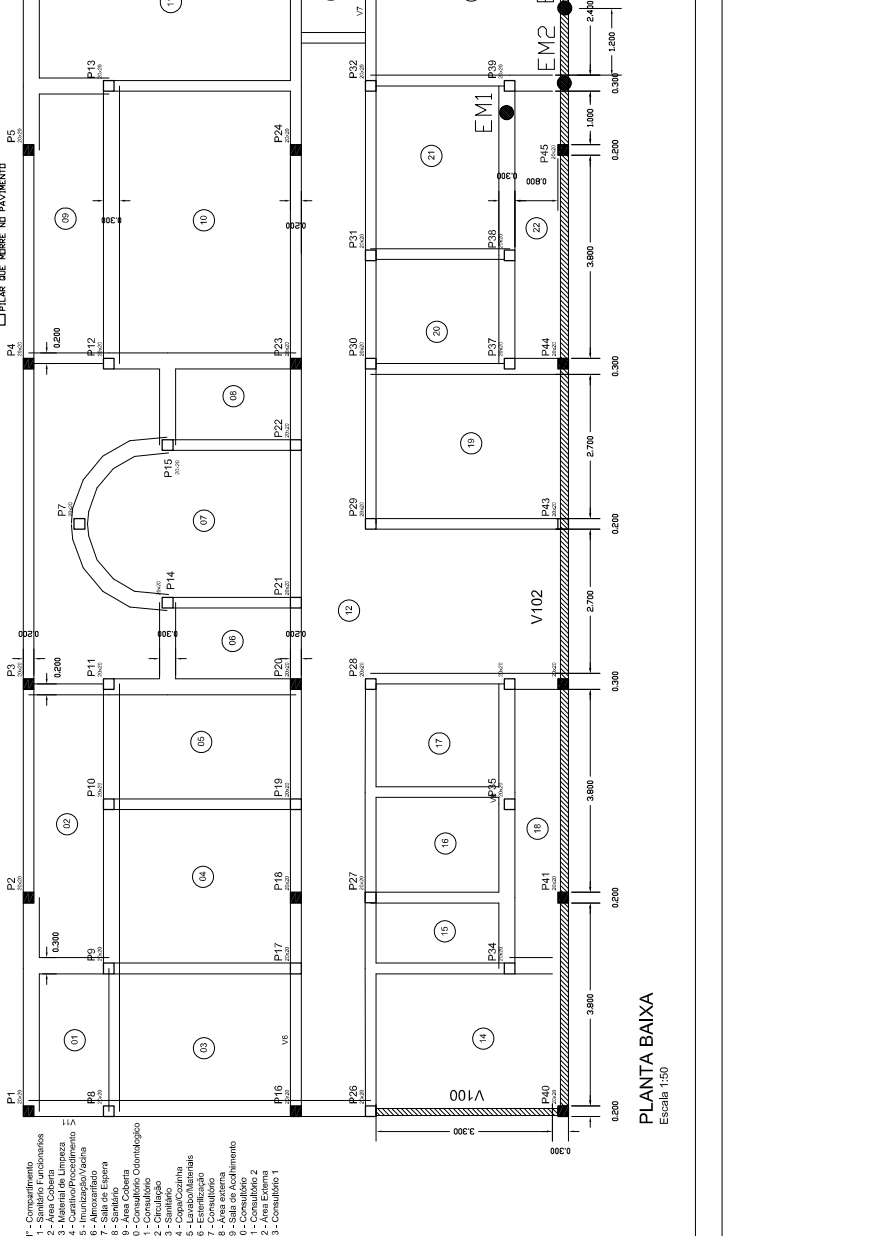

PLANTA BAIXA
Escala: 1:50

Solidus Eng
Engenharia Civil - Estrutural
Rua São Paulo, 100 - Vila São Paulo - São Paulo - SP
FONE: (11) 5082-1000
WWW.SOLIDUS.ENG

REFORÇO DE FUNDAÇÃO E RECUPERAÇÃO ESTRUTURAL

CLIENTE: IBSAÚDE
LOCAL: Rua São Paulo, 100 - Vila São Paulo - São Paulo - SP
INDICADA: INICIADA
TERMINADA: 18/07/2025
RESPONSÁVEL TÉCNICO: ENG. LUIZ ALBERTO FÁRIA
Nº PROJETO DE REFORÇO DE FUNDAÇÃO EM ESTACA MEGA: 571.149
REFORÇO DE RECUPERAÇÃO DE ESTRUTURA DE CONCRETO ARMADO: Tomine
FOLHA: 1/2
SITUAÇÃO/LOCALIZAÇÃO: PLANTA BAIXA, PERFIL DE SONDAGEM, QUADROS

